



**FREMANTLE
ESPLANADE
YOUTH PLAZA**

CONCEPT DESIGN REPORT
PART 2 OF 2

12808 D001
CITY OF FREMANTLE
JUNE 2013
REV 07

CONVIC



CONTENTS

Introduction	4
Design Objectives	5
4. DESIGN DEVELOPMENT	
Spacial Development	8
Design Evolution	10
Stage 1 - Council + SbA Review	10
Stage 2 - Draft Concept Consultation	12
Current Design Proposal	17
5. DESIGN PROPOSAL	
Concept Diagram	20
Programmed Character Areas	21
Context Plan	22
Layout Plan	23
Central Pedestrian Spine	26
Parkour	30
Basket Ball + Table Tennis	36
Skate Plaza	38
Material Palette	45
Planting Palette	46
Furniture Palette	47
Lighting Palette	50
Graphics + Wayfinding	21

DESIGN OBJECTIVES

Using the key outcomes from the two consultation workshops, the findings of the site analysis and reviews of existing strategic documents including the Esplanade Conservation Plan 2010, the Design Principles for the Esplanade Youth Plaza were used to drive the concept design of the project:

THE ESPLANADE YOUTH PLAZA: THE HEART OF THE COMMUNITY

With the Esplanade Reserve at the heart of the City, the Youth Plaza will reactivate the young people of Fremantle and become the heart of the community. Embodying principles of social sustainability, the facility offers opportunities for all participants. It is a central community hub for events, competitions and social opportunities.

CELEBRATING 'WORK HARD, PLAY HARD'; THE CULTURE OF FREMANTLE

The Youth Plaza is a manifestation of the very best of the culture of Fremantle. Interpretative layers are interwoven through the space, using a range of materials to tell the story of the rich history of the city, in particular its working past. Complementing this is the strong skating culture within the community, evident in the unique and challenging skateable terrain that pays homage to the Woolstores edge, making the facility a key destination for local users and national and international visitors.

AN ICONIC, CONTEMPORARY WORLD CLASS FACILITY

With such a strong user community, the skateable/rideable terrain of the Youth Plaza is of a world class standard, ensuring the future growth and development of the sport to the highest standard. The Youth Plaza however, is not just an iconic facility due to its functionality and dynamic uses, but also due to its striking aesthetics and contemporary design, positioning the plaza as one of the flagship public space developments in the City of Fremantle.

A CENTRE FOR RECREATIONAL OPPORTUNITY AND SKILL SHARING

The diversity of the community, and its recreational needs were brought to the fore, and as such, the Youth Plaza offers not only skate/BMX/scooter, but parkour and other informal recreational opportunities. Together with the Dismantle Bike Hub, the facility is a central source of knowledge and skill sharing for the community through workshops and demonstrations, ensuring skill progression and development.

AN INTEGRATED LANDSCAPE AND MATERIALITY APPROACH

The Youth Plaza draws on the rich palette of the landscape within the Esplanade Reserve, and incorporates elements such as trees, indigenous vegetation and a sympathetic material to ensure the facility complements the reserve, and ensuring natural site drainage is maintained. This allows the facility to manifest as a contemporary youth precinct whilst being responsive and sensitive to the heritage significance of the Esplanade.

THE CONCEPT | TO CREATE A COMMUNITY SPACE ACTIVATED VIA COMMUNITY EVENTS, PROGRAMS AND ACTION SPORTS. ENHANCING AN ICONIC PARK SETTING AND CREATING A FOCAL HUB FOR THE COMMUNITY OF FREMANTLE. CAPTURING THE RICH HISTORIC ESSENCE OF SITE WITHIN A CONTEMPORARY YOUTH FOCUSED DESIGN.

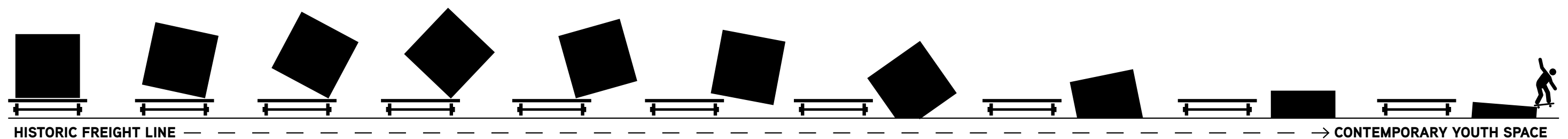

4

DESIGN DEVELOPMENT

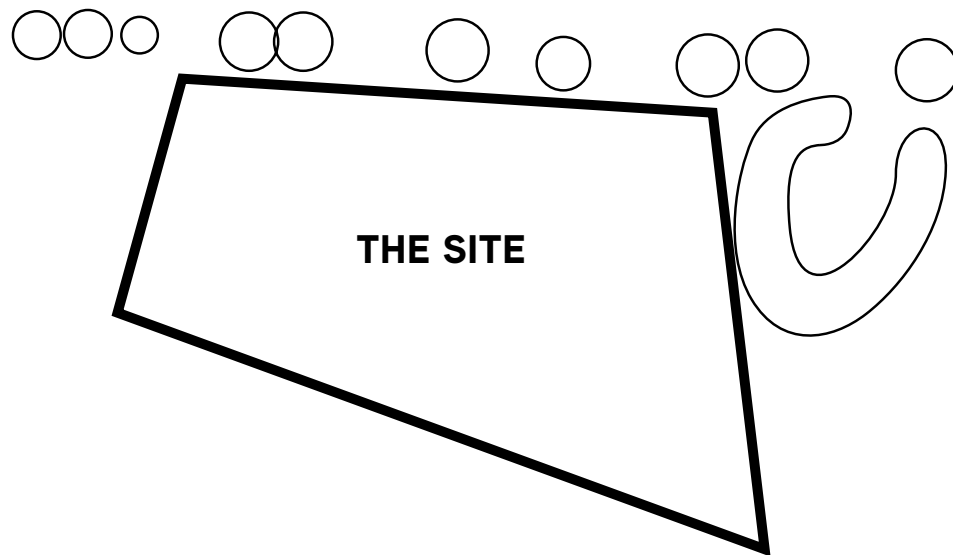

1. EXISTING SITE

The site is currently positioned in the south east corner of the Esplanade Reserve. An avenue of mature Norfolk Pines create the northern boundary to the site with the rail line and park boundary fence to the south. An informal boundary to the west is dictated by the rail line crossing and main desire line across the park. The grass mound offers a topographical boundary to the east. Little level change occurs across the flat site and groundwater levels are only 1m below the existing surface.

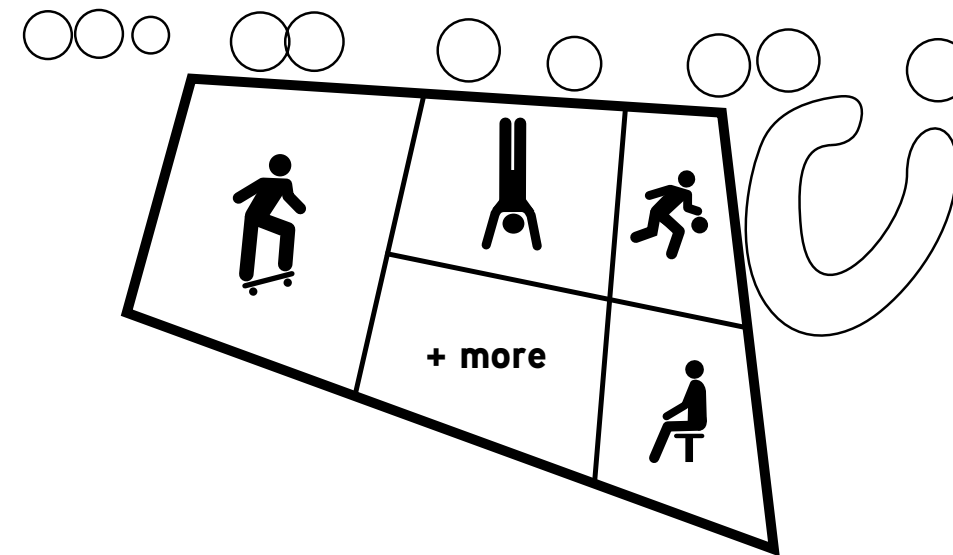

2. CREATE PROGRAMS

The design will incorporate several youth focused programs, but with clear accessibility and functionality to the wider community. This is achieved through a variety of set programs, informal programs and temporary programs. Skate will be integral to the overall space, with integrated parkour opportunities throughout, a basketball half court, and other passive opportunities in other instances allow for users and visitors to rest, relax, spectate, meet, socialise, play, participate, gather and create.

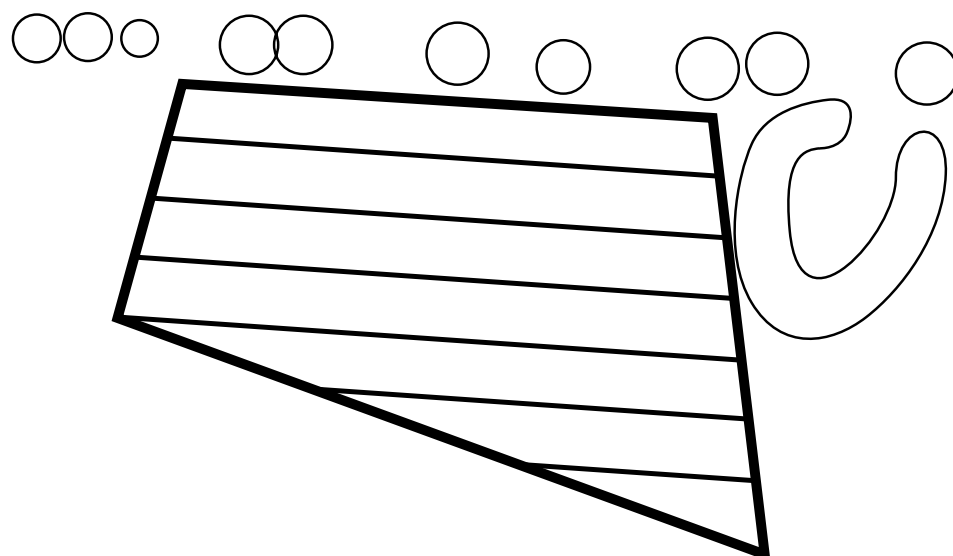

3. ECHOING A LINEAR HISTORY

Fremantle's rich history is woven within the design by making reference to the industrial, rail, port and skate past that makes Fremantle so unique today. Of particular note is the Esplanades historic rail line and existing heritage Norfolk Pines, the neighbouring port and coastal location, and the Woolstores ledge and it's significant importance to skate culture. All these manifest themselves in a linear array subtly reflected in the layout of the design.

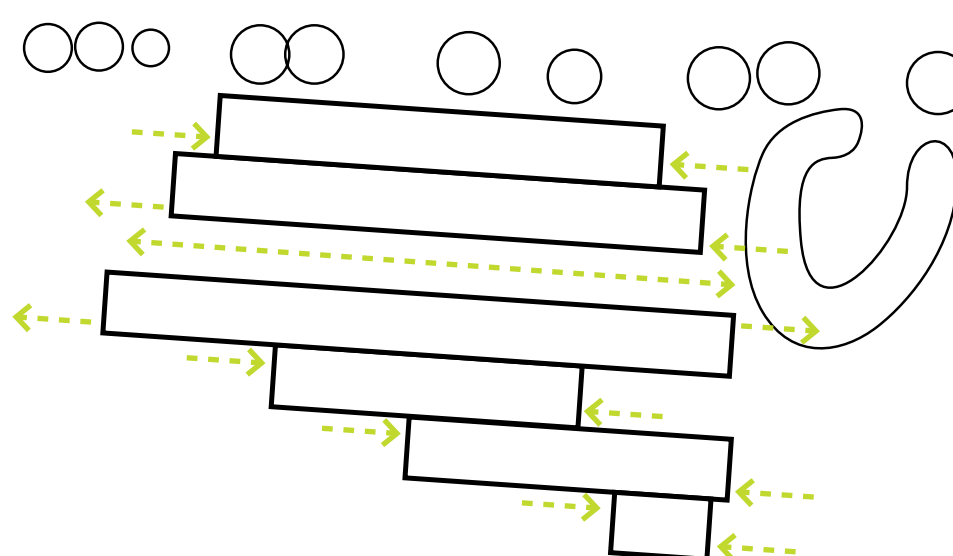

4. INTEGRATING THE LANDSCAPE

Skate infrastructure inherently requires a smooth hard stand surface to facilitate active use and functionality. To mediate between the softscape of the surrounding parkland and the hardscape of the youth space, a coastal landscape responding to the interfaces will integrate the facility into the greater park context and still add a new landscape theme into the reserve.

SPATIAL DEVELOPMENT

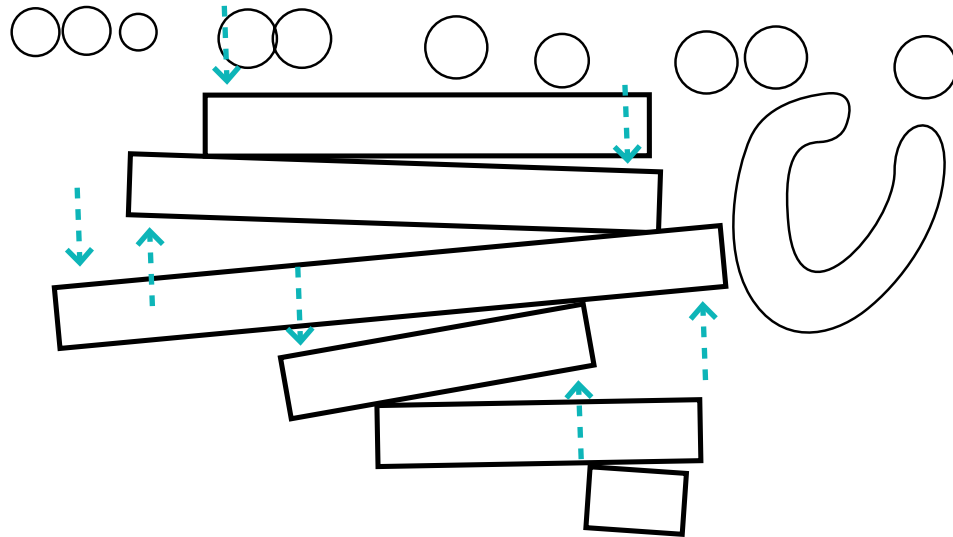

5. CONNECTING SPACES

The linear forms tilt and shift as if lifted by tidal movements to delineate spaces and create varying views and connections. All spaces will connect to allow for continuing movement and flow throughout the space.

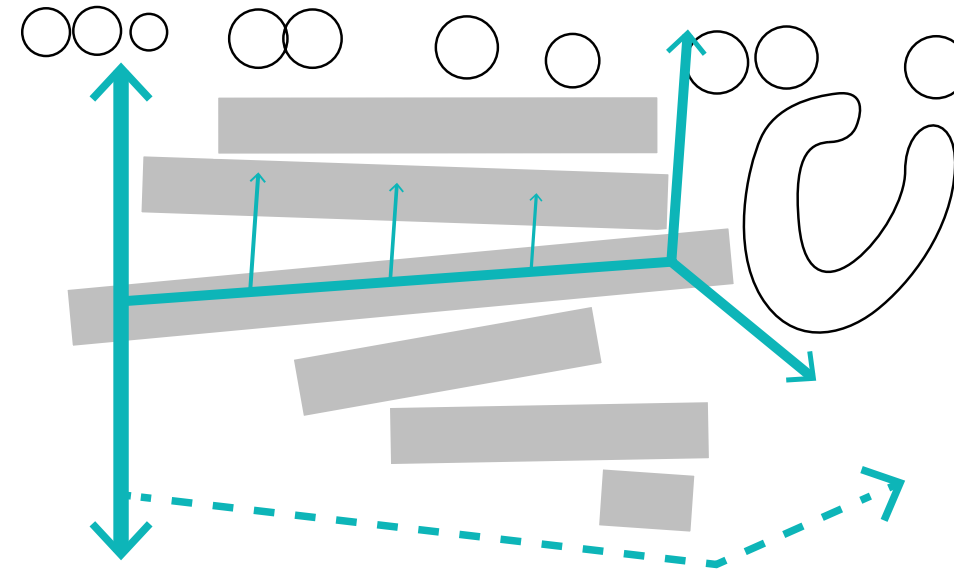

6. DESIRE LINES

Formalising the key north-south route to the west of the site creates an active fringe to the space and a direct route into and through the reserve. Further routes allow for both direct and indirect circulation, increasing opportunities for social interaction and an inviting and welcoming space for all users and visitors

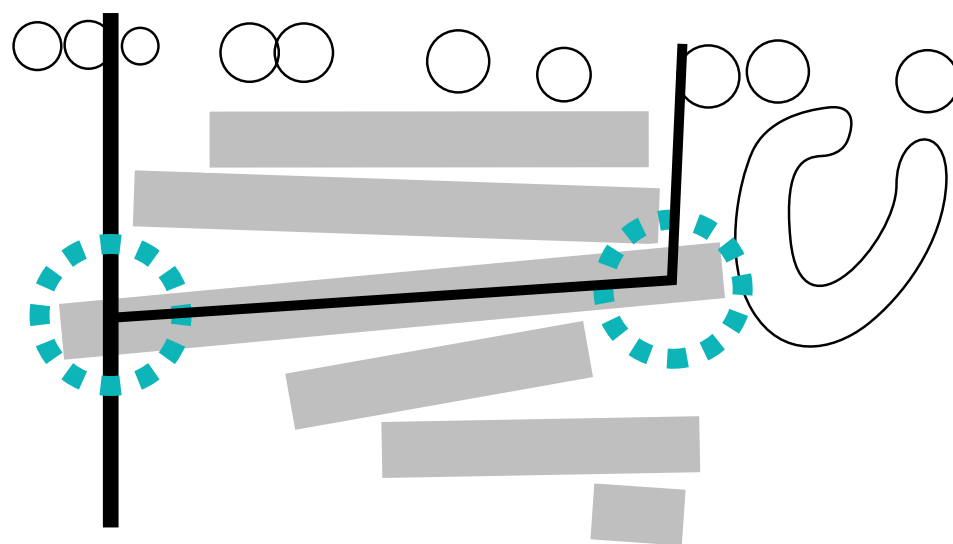

7. NODAL INTERSECTIONS

Key intersections along the main desire lines will be delineated through visual elements. These highlight directional junctions and key vistas, whilst creating entry or nodal statements for the plaza and wider reserve.

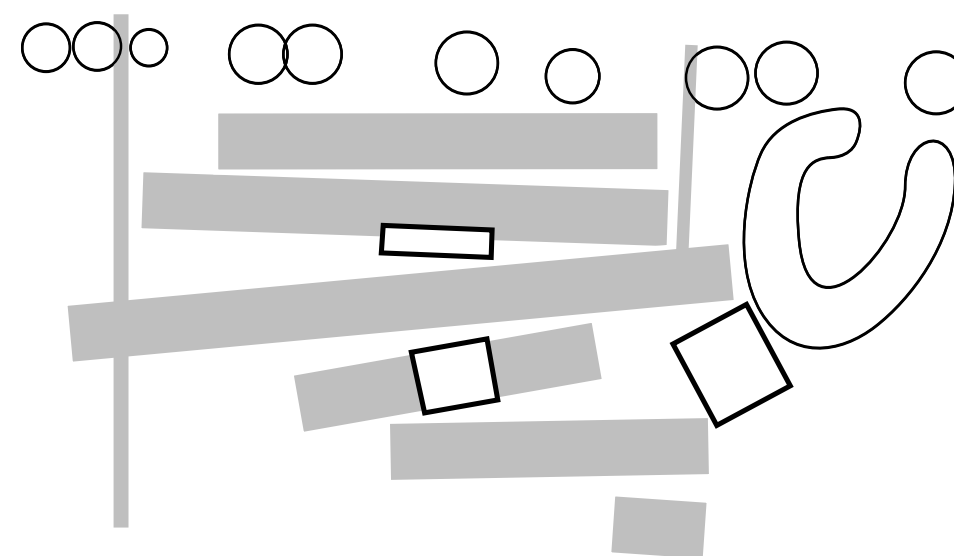

8. CONNECTING COMMUNITY

To increase the usage and success of the design, areas allowing for flexible activation will be situated at key locations. At present 'Dismantle', a bike skill share enterprise currently provide activation to the site. By linking in further groups and social enterprises the space will be constantly utilised. Further groups may include local art groups, skate sculpture, SbA, parkour Australia and other council and public initiatives.



OPTION 1 - RETAINED EXISTING MOUND



OPTION 2 - RE-CONFIGURED MOUND

STAGE 1: CITY OF FREMANTLE & SBA CONSULTATION

Prior to issuing the draft design concept to the Fremantle community, the two draft concept options were issued to the City of Fremantle and SbA, for feedback. Key areas that were to be further developed during the refinement process of the draft design concept included:

- Ensuring access and connectivity both through the site and around the periphery. This is critical to maintaining vehicular access through the site for events, but also ensuring safe movement for pedestrian users.
- The inclusion of lighting within the facility, to increase activation opportunities, particular for events and competitions at night, as well as ensuring the safety of users and that passive surveillance opportunities can be maximised.
- The inclusion of further supporting amenities such as bike racks, BBQ and a table tennis table.

In regards to the functional use of the facility relating to skateboarding and BMX usage, SbA provided the following feedback:

- Appreciation of the landscaping and design themes, particularly incorporating the heritage aspects of the site.
- The inclusion of more street obstacles such as small down rails, larger down rails, hubbas, bump to rails, bump to ledges, manual pad combos will ensure the facility is suitable for larger competitions and major events, for example the WA NIKE SBA AM Series.

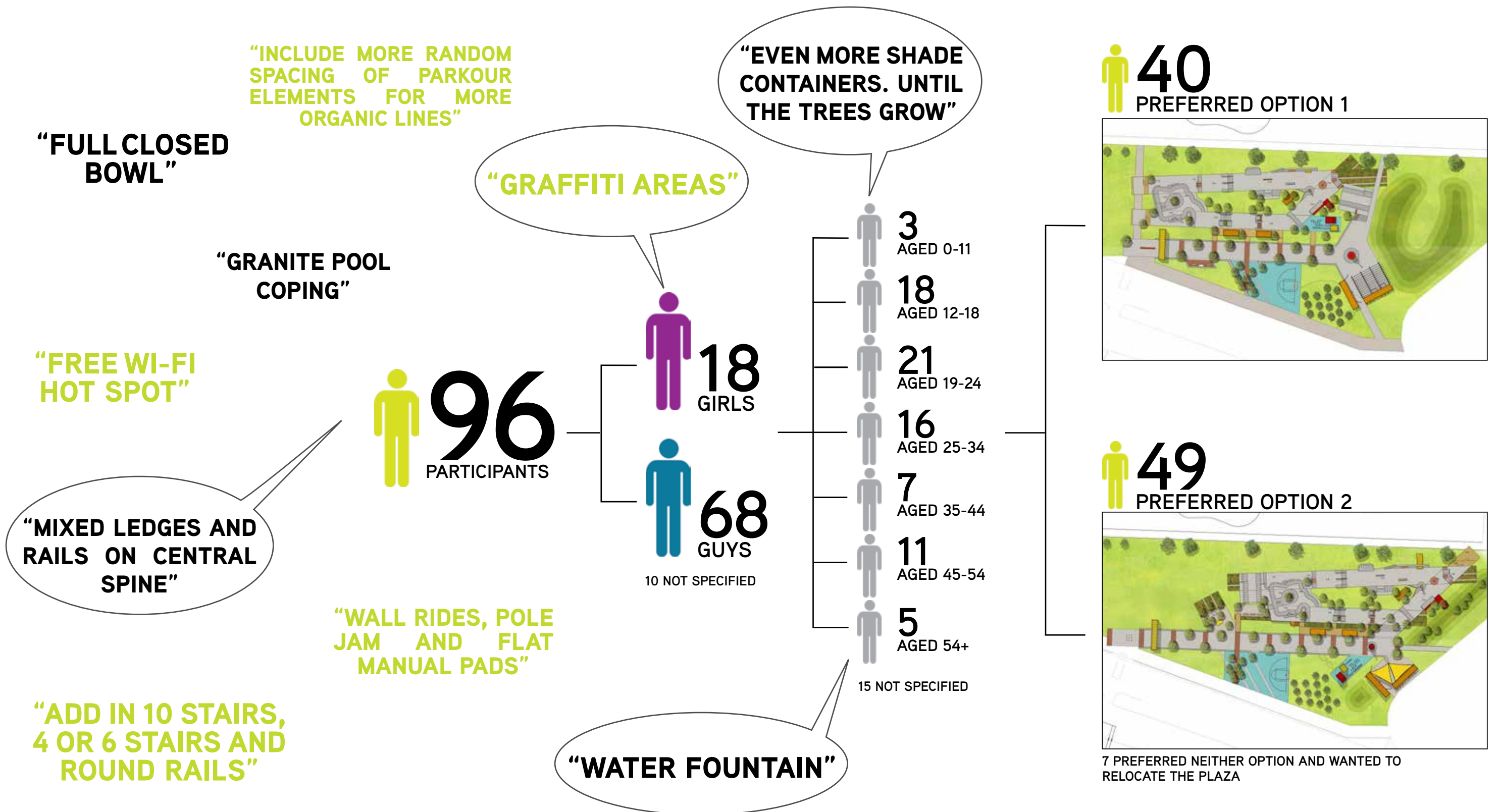

STAGE 2: DRAFT CONCEPT COMMUNITY CONSULTATION

As part of the ongoing design process for the development of the Esplanade Youth Plaza, a draft concept review workshop was held. As well as creating a truly relevant design, this review ensures the final concept design reflects community needs and user requirements. This continued involvement connects the community with the design process and ultimately with the final outcome. This engenders community pride and ownership in both the process and the public facility, creating a strong sense of stewardship of the communities public spaces.

The workshop was held over two days, Friday 22nd and Saturday 23rd of March 2013, at the Fremantle City Council Building. In attendance over the two days were representatives from the Fremantle City Council, local community groups including a mix of BMX, skate, scooter riders and parkour enthusiasts, local residents, business owners and other interested individuals.

The workshops were well attended and provided significant feedback over the two days. Further feedback was collected until the 12th April through an online survey and response feedback forms. This was managed by the City of Fremantle and responses collated and inputted into this summary.

GENERAL FEEDBACK SUMMARY

Overall, the draft concept was well received, with positive feedback from both Council and users with regards to the unique style, integrated and multi-use space and overall design of the youth plaza. In particular the following items received positive feedback and were listed as favourable outcomes in the draft concept design:

SKATE COMPONENTS

The long continuous street run (central spine) was well received, as were the standardised skate elements including stair sets, hubbas, rails and gaps included in the main skate area. The creative and unique skate qualities, along with the flow across the park were also popular.

PARKOUR COMPONENTS

A popular response for the parkour elements was for the material selection and the variety of the elements including the unique usage of shipping containers. Other favourable elements included the posts connecting to the main plaza, the density of the layout, the waist height walls and rails. The adaptation of the sea containers as a multifunctional space with varying levels, created a unique feature for parkour users.

SUPPORTING FEATURES AND AMENITY

The youth space works well with the provision and placement of the BBQ area, additional trees for shade, with further shade provision provided through the shelters and the integration of the sculptural buoy.

THE SOCIAL AND ACTIVATED SPACE

The key to the youth plaza is its overall social activation. From the draft design these major themes resonated with the community. The open areas allow for an inclusive atmosphere and social spaces. The integration of the mound as seating for open air

cinema and the integration of public art into the overall concept development were commented on, proving the community are in support of a integrated and holistic youth space.

The following additional comments provided were for items that could be developed and/or refined continuing on through the design process. These included:

SKATE COMPONENTS

The inclusion of a large closed bowl to complement a “world class park”. This is an item considered for transition skaters with advanced skills.

The requirement to increase the number of stairs creating a more advanced competition level stair set and also creating other smaller stair sets for less advanced skaters.

To increase the heights of transition elements and add kerbs and road barriers to trick up the transition areas. Providing finer detail on the mix of square section rails and round section rails, granite pool coping, mixed ledges and rails along the central spine along with wall rides and grass gaps.

Also a sheltered mini ramp was suggested, but also many comments also suggested that mini ramps already existed around the Fremantle area and may not be warranted for this site.

PARKOUR COMPONENTS

More liaison will be carried out with the Australian parkour association to develop the finer details for optimum usability of the facility. Suggestions put forward to facilitate this included: spacing posts at varying intervals, adding climbing grips to the adopted containers, randomised walls and rails, and the inclusion of random spacing for freer movement lines and actions.

Other ideas included the provision of a transformable structure and the integration of parkour elements with skate elements along the outer edge, creating shared space without interrupting each others flow and use, adding space and rigging points for Fremantles circus school.

This dovetailed with design response to keep the main parkour section small and creating courses and flow around the larger youth space by distributing elements throughout.

THE SOCIAL AND ACTIVATED SPACE

Features the community responses indicated required further input included the provision of wooden seating platforms, drinking fountains, more seating and picnic tables. An extension of this included the addition of a water feature for summer and shade provision over the BBQ area. Consideration was sought for how the containers may be adapted for all weather shelters.

Other elements the community provided comment on were music speakers, WI-FI connectivity, exhibition space or graffiti space on the wall of the shelters and a general requirement for access for all to viewing areas.

CONCLUSION SUMMARY

The draft design community workshops were extremely successful and positive with regards to draft design appraisal and feedback. The participants of the workshops and the feedback from the consultation assist in the broader understanding of the community and user requirements.

Many of the community comments provided are items that will be naturally addressed in the next phase of the design, such as overall CPTED design principles and the overall resolution of spatial requirements. Also further detailed design resolution will respond to comments that question specific elements such as rail profiles.

The community and user feedback included significant amount of additional items to include in the design. Major elements included a bowl, additional shelters, more element for skate and parkour and public furniture. While this feedback is constructive, the limitation to include all requests into the final concept design is the budget allowance for the youth plaza.

The next phase will review the selected design option and consider the most apt changes to undertake to ensure an integrated, multipurpose, multifaceted youth space.



OPTION 1 - RETAINED EXISTING MOUND

SELECTION OF PREFERRED OPTION

Further to the outcome for the selection of the preferred option, being 45% for option 1 and 55% for option 2, CONVIC provide the following advice and recommendations with regards to support for the preferred option 2. A number of factors are considered to assist in making the decision for the preferred design option. These include the following:

1. The consultation process, outcomes and final collated results.
2. The potential for adjacent future development or youth space extension.
3. The relationship of the Youth Plaza design with the existing park.
4. The qualities and effects of the existing mound
5. The potential offered by reconfiguring the mound

THE CONSULTATION RESULTS

The outcome of the consultation phase and results of the survey indicate that option 2 as the favoured design. Although the resultant figures do not show a standout option winner, there is a significant difference with respect to the number of people that selected option 2 and had attended the consultation event versus those that did not attend and often favoured option 1. This result may be attributed to the fact that those attending the event were able to view the design presentation, giving them a more comprehensive understanding of the potential of the design options. Although, based on the consultation process the outcomes suggests the majority selected option 2 as the preferred design.

The main considerations for the preferred selection of Option 1 was for two main reasons;

- A. Being its current functionality within the reserves setting; and
- B. For its historical context and interpretative significance.

The mound is currently used as a spot for relaxing, sun bathing and picnicking, and is the single vantage point within the park. These properties were significantly favoured within the consultation process. This extended to principles for Option 2 to include earthworks that offer these similar properties. Although the mound's historical significant is somewhat recent, it seems to be very relevant with many peoples and context of the park.

POTENTIAL FOR FUTURE DEVELOPMENT

The council has indicated there is a possible opportunity for the car park adjacent to the development site to be developed in the future. Although there are currently no set plans for development to occur, it is key consideration in understanding existing and potential future links into and from the site.

In this context, if the car park was to be developed in the future, option 2 would offer a far stronger connectivity, views and circulation route to not only the plaza, but to Esplanade Reserve and the wider Esplanade precinct.

Option 2 also offers of building stronger and greater connectivity to the links to both Norfolk St. and Essex St.



OPTION 2 - RE-CONFIGURED MOUND

THE DESIGNS RELATIONSHIP WITH THE EXISTING PARK

Both the options offer a similar relationship with the existing park by maintaining, ostensibly the same facility design, however the extra space created by reconfiguring the mound in option 2, offers greater spatial qualities to both the east and south of the design. It will continue to act as a landscape buffer between the existing carpark and the greater park reserve, including tree planting.

Option 1 – maintains stronger links into the wider park by formalizing the entrance path from the rail crossing. The design would, however, benefit from and become more coherent with additional formalized connections across the entirety of the park and to the city centre.

Option 2 – inherently frames a more centralized lawn space within the park, as the reconfigured mound allows the design to be move towards the adjacent car park. This in turn creates a flexible lawn space that is intrinsically connected with the plaza. This would allow for a spill out for larger event audiences and an area for parents that have both young children on the playground and older children using the youth plaza.

Both designs look to maintain the fundamental properties that the mound offers, for observation, relaxing, play and screening from the adjacent car park.

THE EXISTING MOUNDS PROPERTIES

The existing mound as highlighted above has several advantageous qualities that aim to be maintained within both options. The form of the existing mound does however have some draw backs due to its enclosed nature based on Crime Prevention Through Environmental Design (CPTED) and ‘Safety by Design’ principles. The horseshoe form of the existing mound creates a enclosed space that is not ideal in public open space. Option 2 looks to address this by reconfiguring the mound to a linear form while still maintaining the screening and buffer qualities.

CONCLUSION

Considering the above factors, the outcomes of the consultation and the site analysis, CONVIC recommend the endorsement of option 2 as it meets the majority of community needs, response to brief and flexibility for future works.

CURRENT DESIGN PROPOSAL

LAYOUT REFINEMENT

The initial draft design has been modified in scope and size to meet with the allocated \$1.2m budget. The main components of the concept have been retained while the extent of area has reduced. The changes and modifications are as follows:

- The overall design has been raised above existing levels. The main street passage from Essex Street has been considered as a view corridor through and across the reserve and plaza and has been impeded on slightly due to the location of infrastructure within the park.
- Central spine reduced in width from 10m to 2.5m.
- Youth Plaza reconfigured to ensure 10m offset from existing Norfolk Pine tree line.
- Earthwork and mounding is created to moderate the impact of the plaza features in the park and double to create varying spectator and refuge areas.
- Connection point to existing eastern footpath is refined.
- The arrival gateway area has been reduced in size.

SKATE REFINEMENT

- Reconfiguration and modification to the draft concept for the skate flow area led to an enclosed bowl as the most appropriate response to skate space.

PARKOUR REFINEMENT

- Poles and frame repositioned within existing group of Norfolk Pines.
- 1 no. Parkour specific container remains within parkour area.

AMENITY REFINEMENT

- Existing concerted shipping container shelters have been repositioned to an alignment that better suits the configuration of the youth plaza.
- Gateway feature reconfigured into the back of skate plaza quarter pipe and also works as balustrade.

REMOVED ITEMS

(Potential future additions)

- BBQ area removed.
- The basketball court hardstand and associated parkour walls has been removed.
- 1 no. Shelter located on the eastern side of the bowl.

FEATURES FOR ADDITIONAL FUNDING

- Dismantle container relocation and decking area
- Landscape planting including trees.
- Basketball court hardstand.
- Extended skate plaza.
- Connection paths to the wider context of the Esplanade Park.
- 1 no. Shelter.

5

DESIGN PROPOSAL

FREMANTLE ESPLANADE YOUTH PLAZA
CONCEPT DIAGRAM

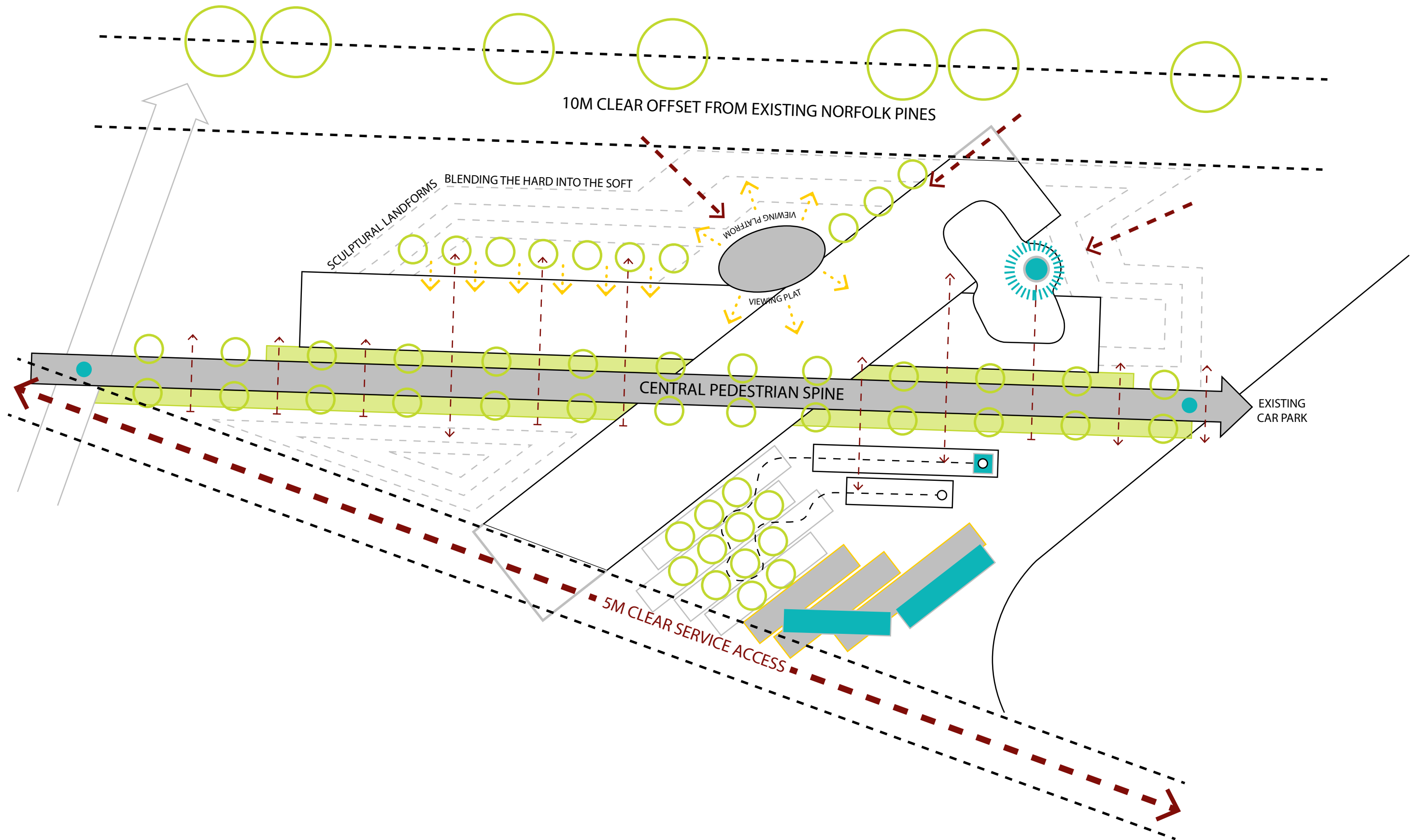

PROGRAMMED CHARACTER AREAS

THE CONCEPT DESIGN HAS A NUMBER OF CLEARLY DEFINED SPACES THAT RESPOND TO PROPOSED USES AND TO THE EXISTING SITE CONTEXT. THESE ARE 'ZONES' THAT INFORM THE OVERALL STRUCTURE AND COMPOSITION OF THE CONCEPT DESIGN, AS DESCRIBED BELOW:

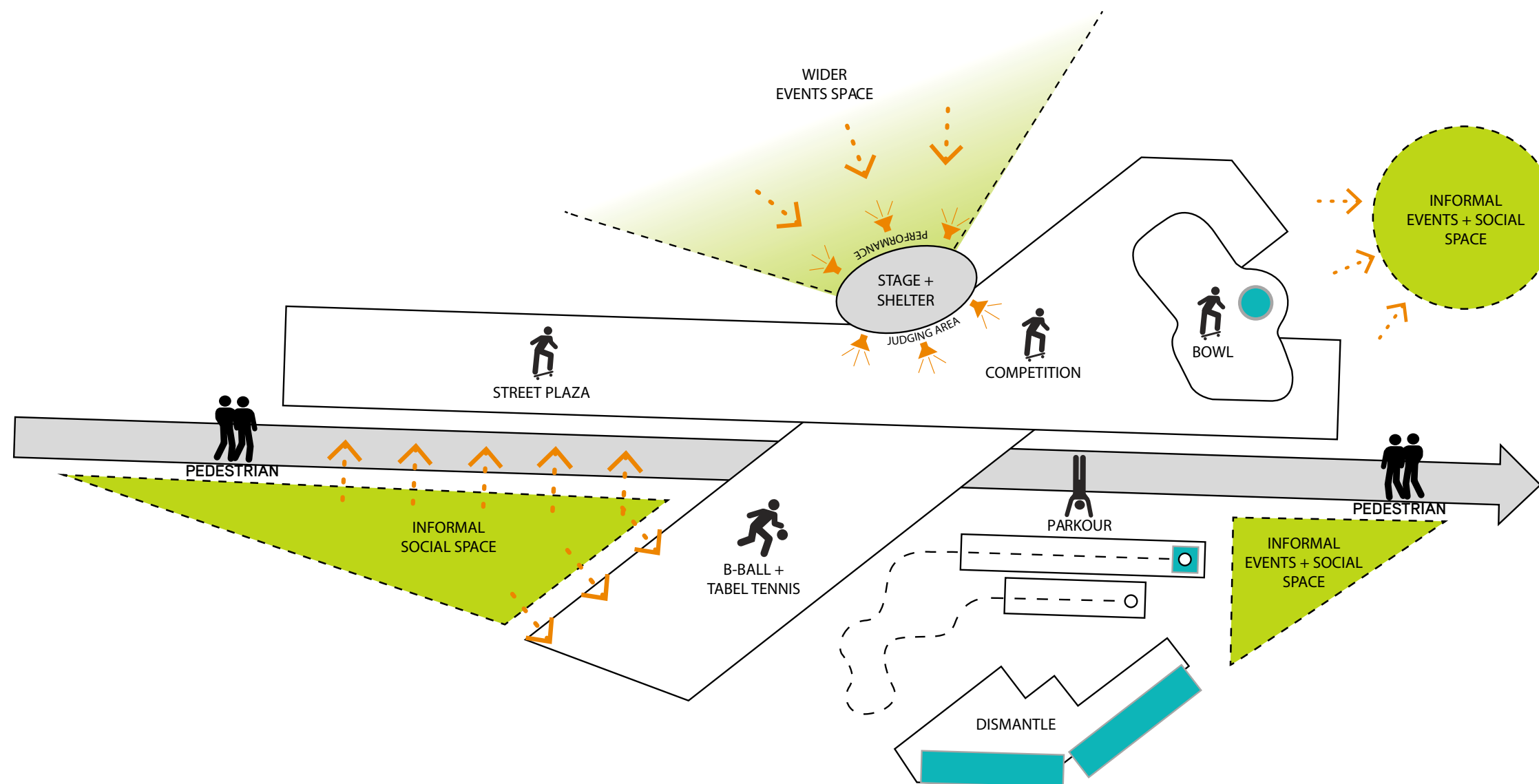

PEDESTRIAN

Abroad open promenade, acting as conduit and transition space through the reserve. It offers a treed avenue with views across the space and a relaxed meandering stroll sensibility. It facilitates easy transitioning between spaces and along the facility.

STREET PLAZA

A low profile skate plaza with unique street elements and transition flow area, all connected to create continuous skate runs. Materiality provides different skate textures and unique obstacles.

BOWL

A skate bowl provides the main transitional skate area within the plaza. Although the bowl, at its deepest reaches only 1.5m deep, various extensions and the integration of a reclaimed shipping buoy provides a challenging skate environment for more advanced and intermediate skaters.

COMPETITION STREET

More challenging street skate elements are focused in the central space of the plaza, allowing large competition events to be held in this area. Obstacles have been picked to challenge skate users, but also provide a setting that can accommodate varying skill levels for both everyday usage and competitions. This area has a close relationship with the stage and shelter for judges to sit and view competitions.

B-BALL + TABLE TENNIS

On the south side of the central spine an area is created to accommodate a half basketball court. This is to be a staged element and constructed in a later phase, but in the interim will accommodate outdoor table tennis facilities that will be later relocated once the basketball is constructed.

PARKOUR

The parkour area consists of several key elements, such as; varying height and angled walls, a steel scaffolding frame, balance poles and beams, a soft fall strip and a converted shipping container on end, which creates an iconic feature to this area.

DISMANTLE

The existing not-for-profit bike maintenance facility 'Dismantle' has been retained and reconfigured with a new deck into the youth plaza. The relationship with the existing trees has been maintained to allow continued usage of the shade that the trees offer.

INFORMAL SOCIAL + EVENTS SPACES

Throughout the Youth Plaza several pockets of grass lawn have been positioned to provide informal social areas perfect for picnicking and hangingout in large groups. These areas also provide ideal locations for informal and temporary events, each with a different scale and layout for varying event types and scales.

WIDER CONTEXT PLAN

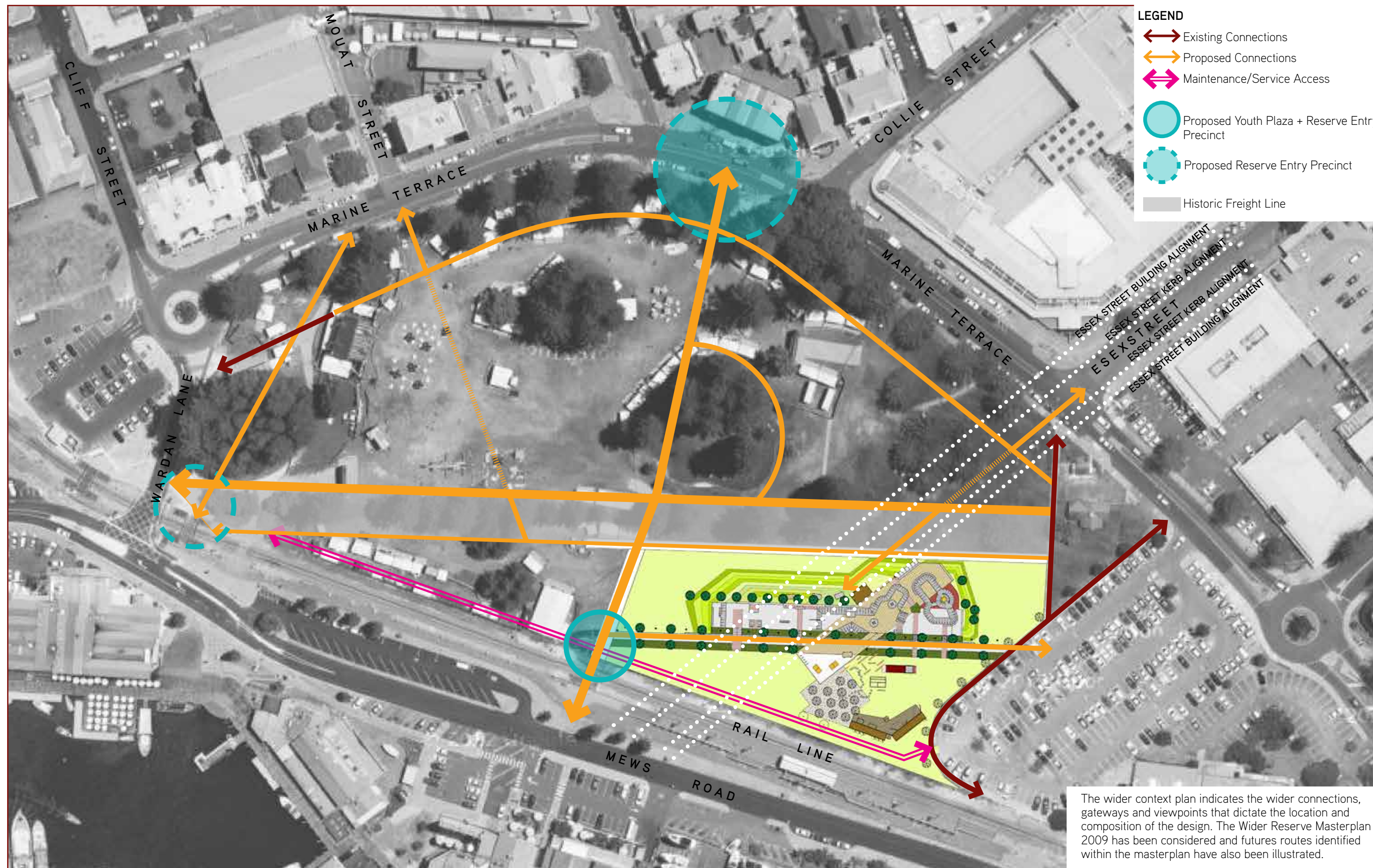

LAYOUT PLAN



FREMANTLE ESPLANADE YOUTH PLAZA
PLAZA OVERVIEW

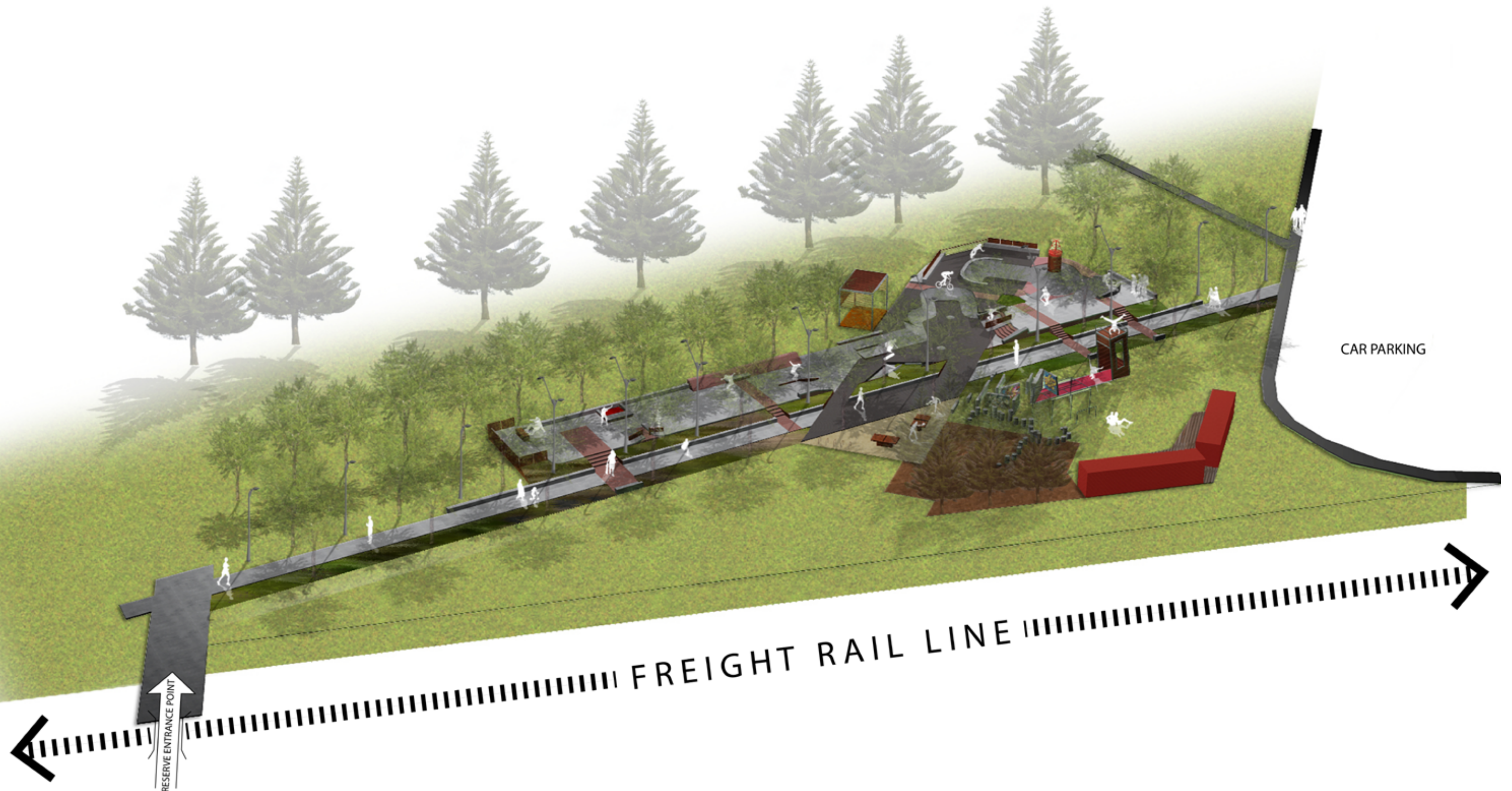

VIEW TOWARDS MEWS ROAD

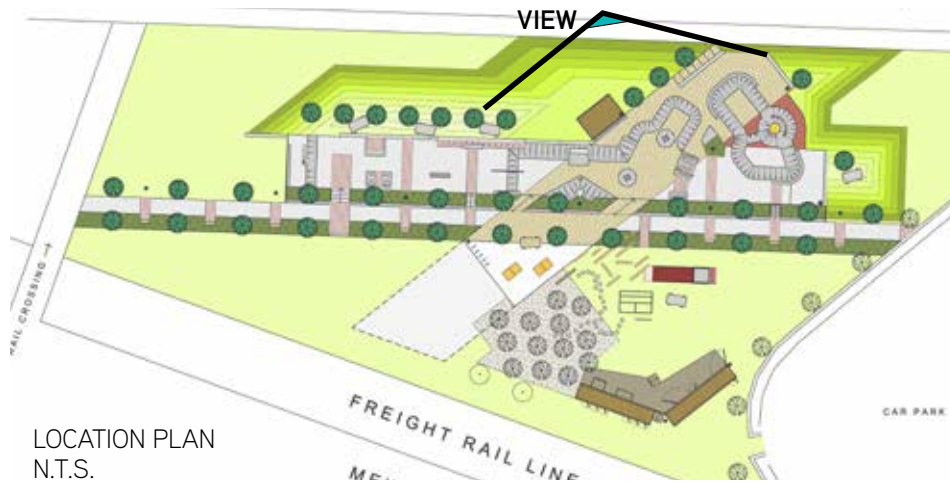



CENTRAL PEDESTRIAN SPINE

2: CENTRAL SPINE

A broad open promenade, acting as a conduit and transition space through the reserve. It offers a treed avenue with views across the space and a relaxed meandering stroll sensibility. It facilitates an easy transition between spaces and along the facility.

The central spine creates a unique linear corridor that acts as the major artery through the plaza. The long run provides a continuous skate line that is unique in this setting. The inclusion of red brick pavers to create breaks in the ground surface treatment highlight secondary routes into other key areas.

Large steel panels create an iconic and visual gateway into the plaza which has a double function as a balustrade to the back of the quarter pipe platform. This feature acts as a notice board for up and coming events and other community, user and visitor information.

Strategically placed concrete ledges offer street style skate opportunities that echo those of the Woolstores ledge. Other ledges are positioned to offer safe seating opportunities for nonusers and spectators. The cloaking concrete surround provides the ideal durability for seating and a skateable feature.

The treed avenue emphasises the strong linear character of the space, framing the corridor and providing natural shade and amenity along the entirety of the spine.



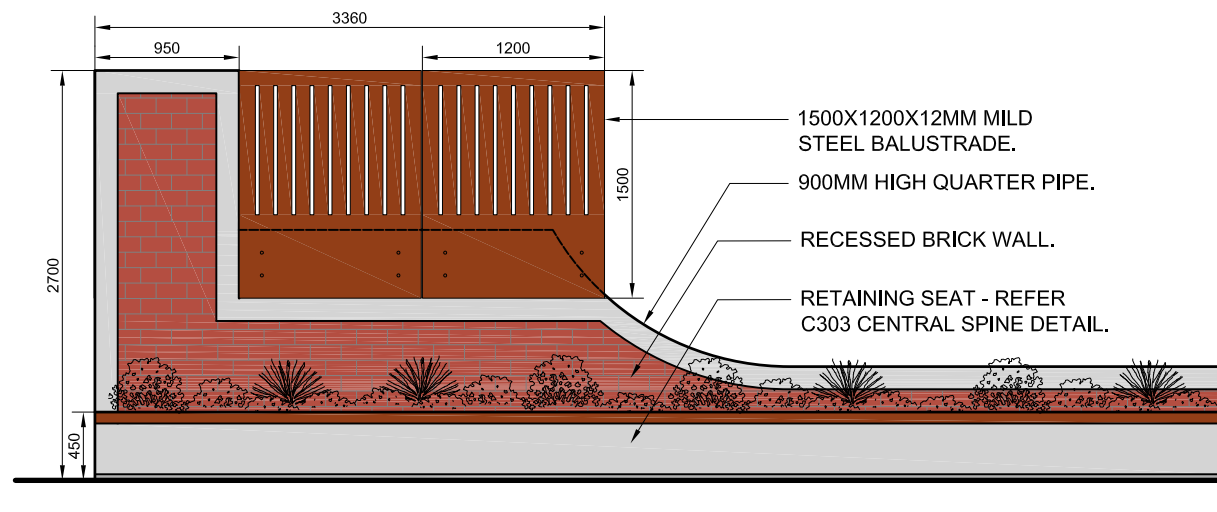

301
A QUARTER PIPE FEATURE WALL - SIDE ELEVATION
SCALE 1:50

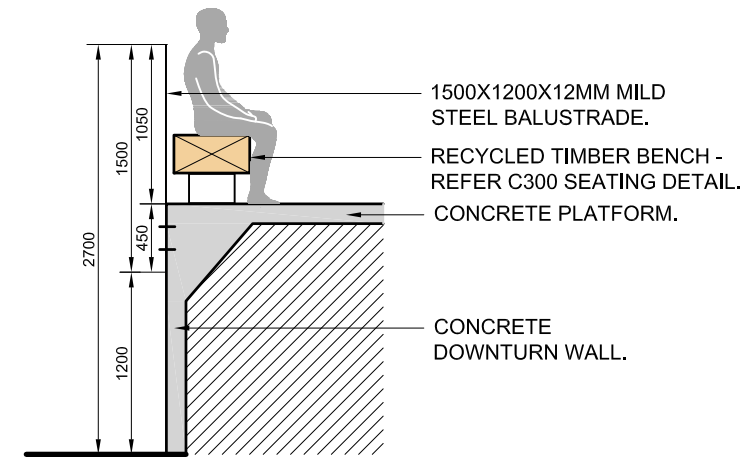

301
B BALUSTRADE SECTION
SCALE 1:50

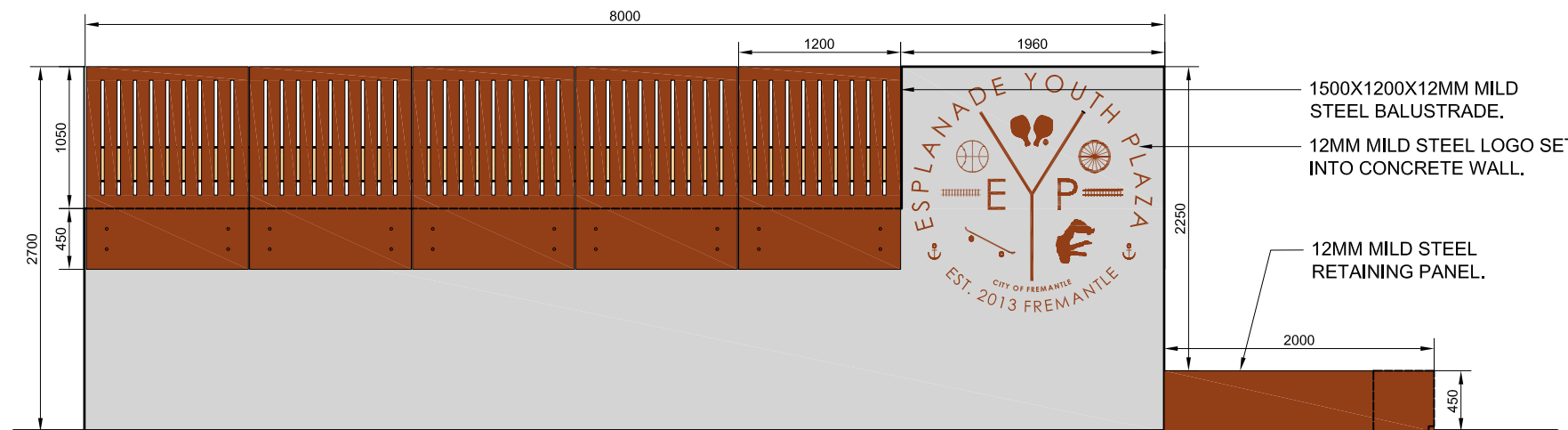

301
C QUARTER PIPE FEATURE WALL - REAR ELEVATION
SCALE 1:50

CONVIC

unit 13 46/50 regent street richmond victoria - australia - 3121
ph: +613 9486 9899 fax: +613 9486 9088 www.convic.com

Project
Esplanade Youth Plaza
Esplanade Reserve,
Fremantle, WA

Drawing Title
QUARTER PIPE FEATURE WALL

Drawn	Checked	Scale	Date
AH (CONVIC)	NL (CONVIC)	1:100 @ A1	03.06.13

Drawing Number	Revision
12808_C301	-

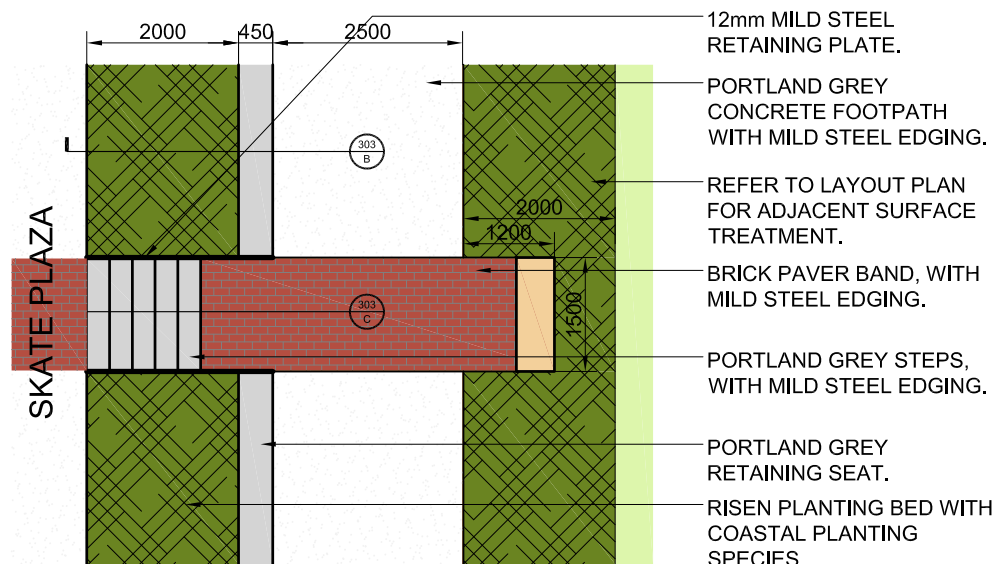

303 A TYPICAL CENTRAL SPINE PLAN
SCALE 1:100

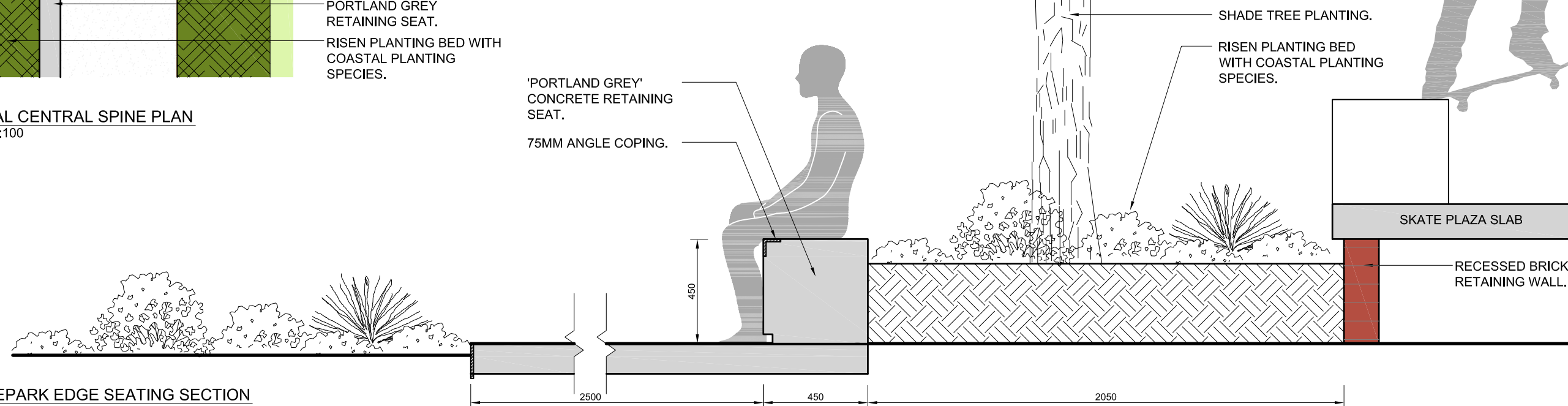

303 B SKATEPARK EDGE SEATING SECTION
SCALE 1:20

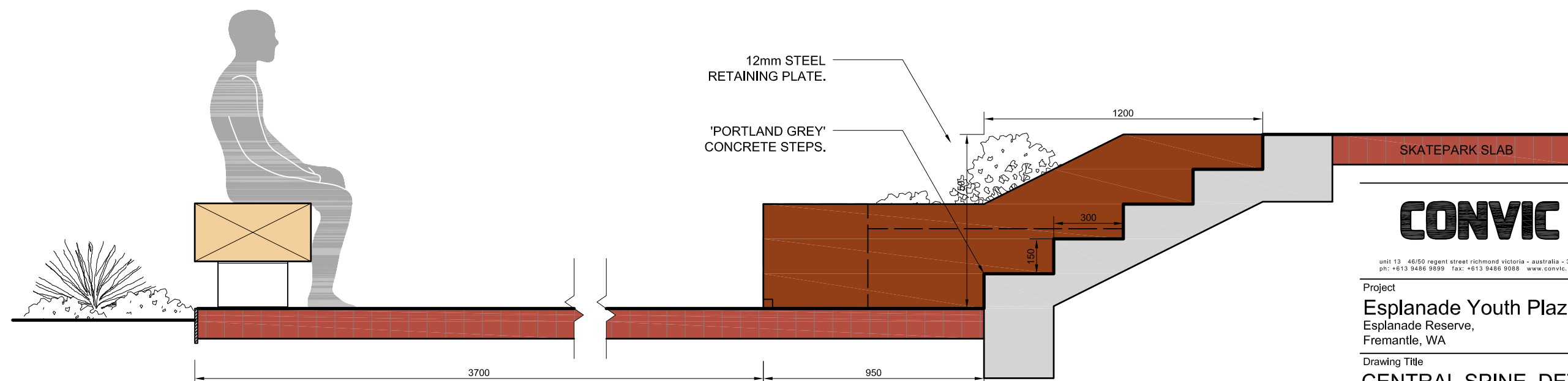

303 C SKATEPARK STEPPED ACCESS SECTION
SCALE 1:20

CONVIC

unit 13 46/50 regent street richmond victoria - australia - 3121
ph: +613 9486 9899 fax: +613 9486 9088 www.convic.com

Project
Esplanade Youth Plaza
Esplanade Reserve,
Fremantle, WA

Drawing Title
CENTRAL SPINE DETAIL

Drawn	Checked	Scale	Date
AH (CONVIC)	NL (CONVIC)	1:100 @ A1	03.06.13

Drawing Number	Revision
12808_C303	-

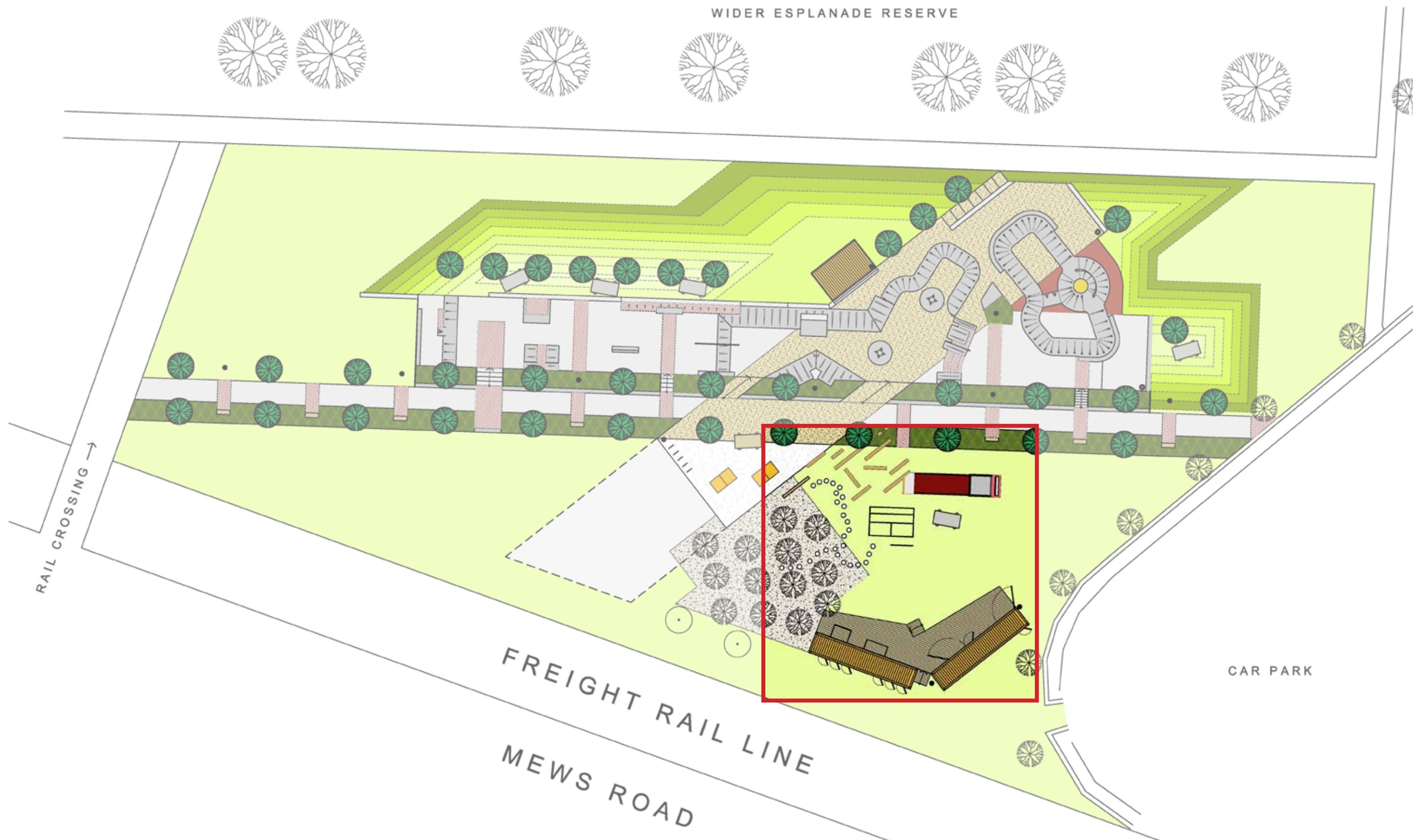

PARKOUR AREA

PARKOUR

The existing stand of Araucaria (Norfolk) pines are utilised as a back drop to the main parkour focused area. Timber posts on end create balancing paths through the trees leading to the steel scaffolding climbing frame. Parkour as an active sport will feature throughout the entirety of the Youth Plaza, but will be concentrated within this area creating an integrated active node for users. Varying concrete walls and an adapted shipping container will create unique parkour elements set within a soft fall area.

DISMANTLE

This area also includes space for social enterprise activities and links 'Dismantle' within the plaza. This active role within the social fabric of the site will positively add to the overall programming of the space and provide wider community function through skill share, workshops, events and the occasional outdoor cinema.



VIEW TOWARDS PARKOUR

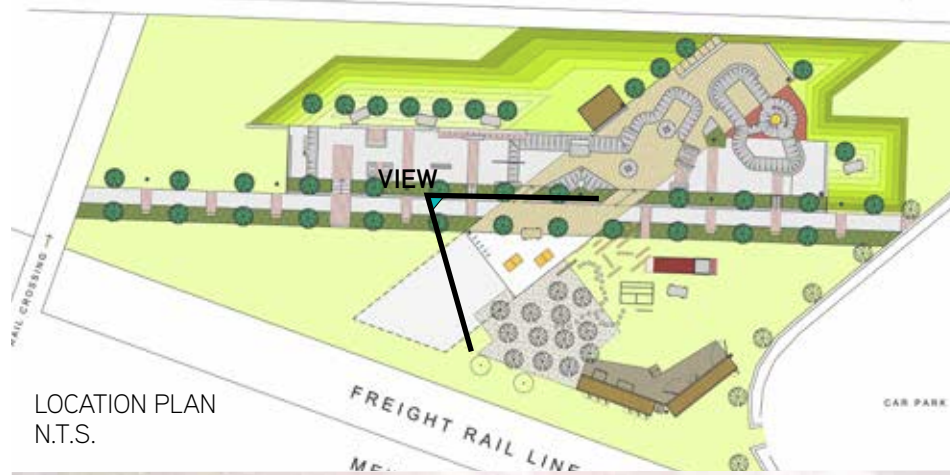

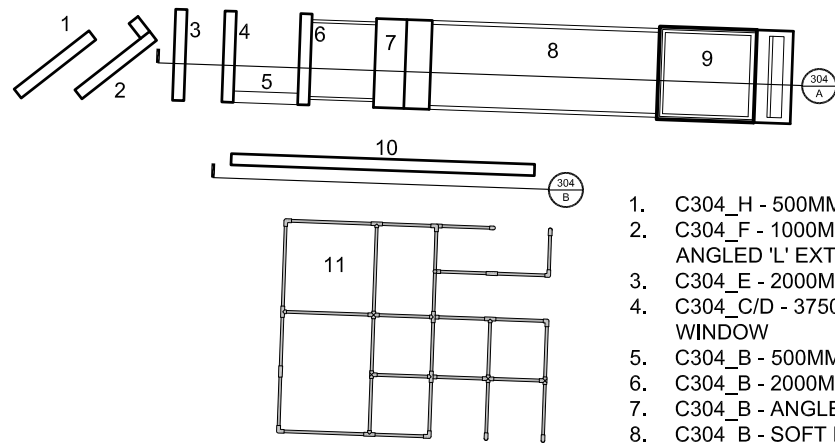

1. C304_H - 500MM HIGH WALL
2. C304_F - 1000MM HIGH WALL WITH ANGLED 'L' EXTENSION
3. C304_E - 2000MM HIGH WALL
4. C304_C/D - 3750MM HIGH WALL WITH WINDOW
5. C304_B - 500MM HIGH WALL
6. C304_B - 2000MM WALL WITH STEEL BARS
7. C304_B - ANGLED WALL
8. C304_B - SOFT FALL RUBBER SURFACING
9. C305_A - CONVERTED CONTAINER
10. C304_G - LOW ANGLED WALL
11. C306_A - STEEL FRAME

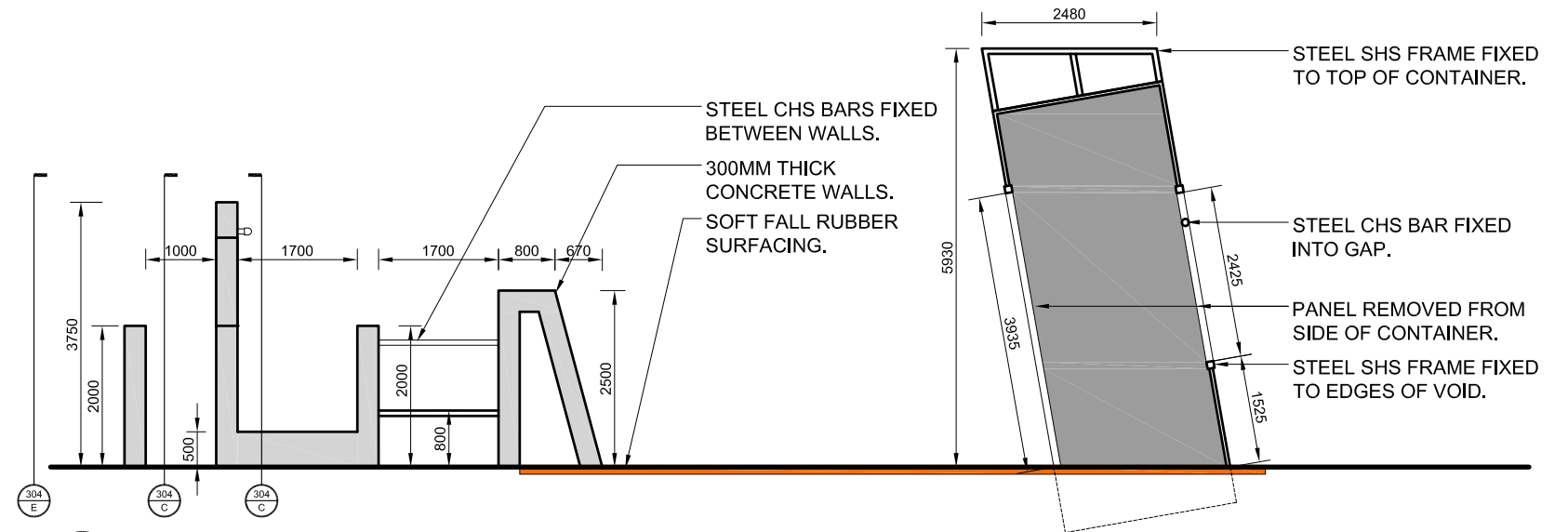

304 B WALLS AND CONVERTED CONTAINER SECTION
SCALE 1:100

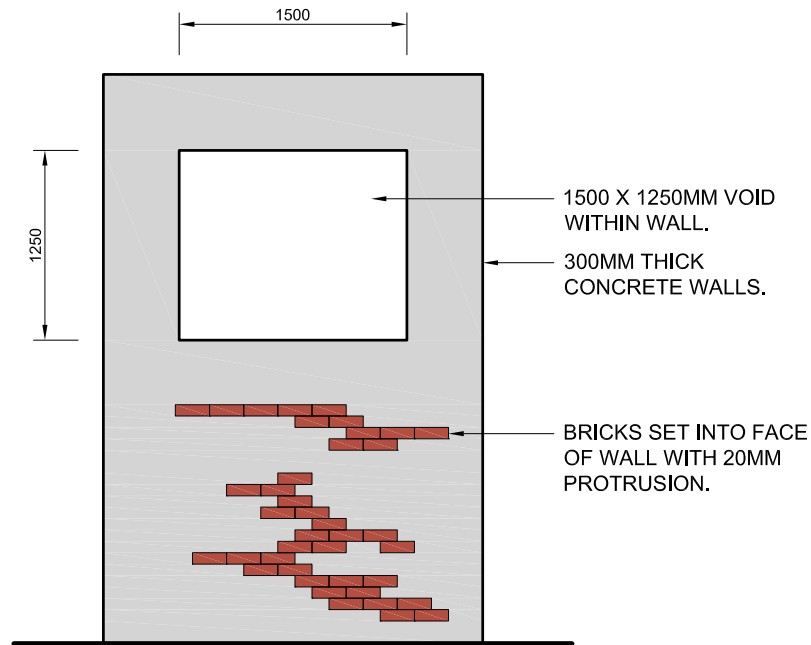

304 C 3750MM HIGH WALL WITH WINDOW - ELEVATION
SCALE 1:50

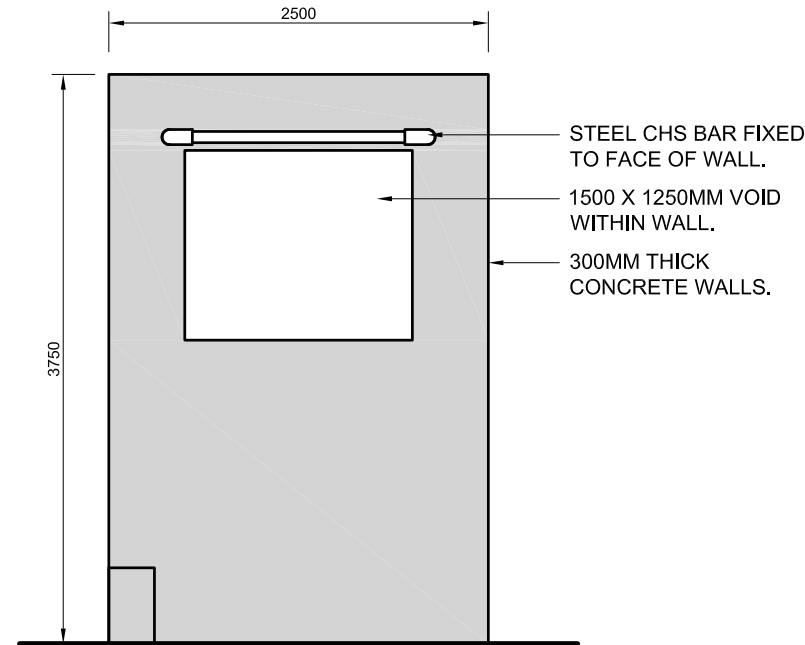

304 D 3750MM HIGH WALL WITH WINDOW - ELEVATION
SCALE 1:50

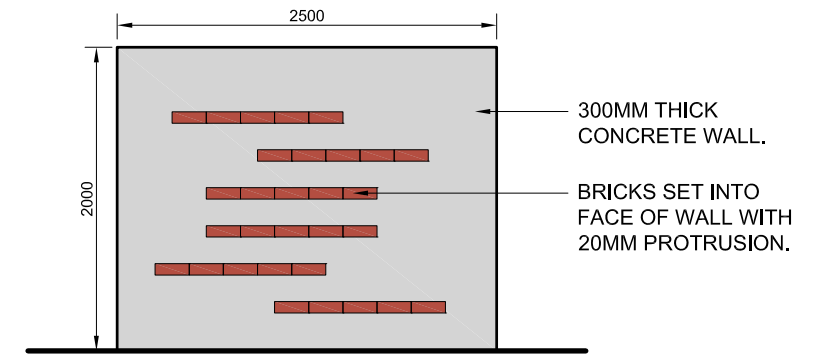

304 E 2000MM HIGH WALL - ELEVATION
SCALE 1:50

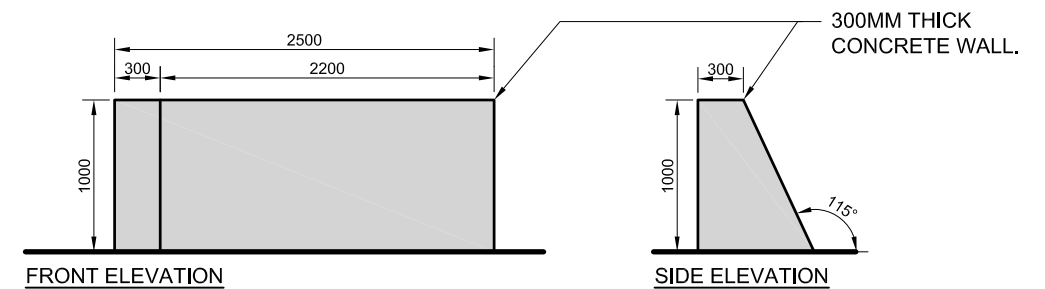

304 F 1000MM HIGH WALL - ELEVATION
SCALE 1:50

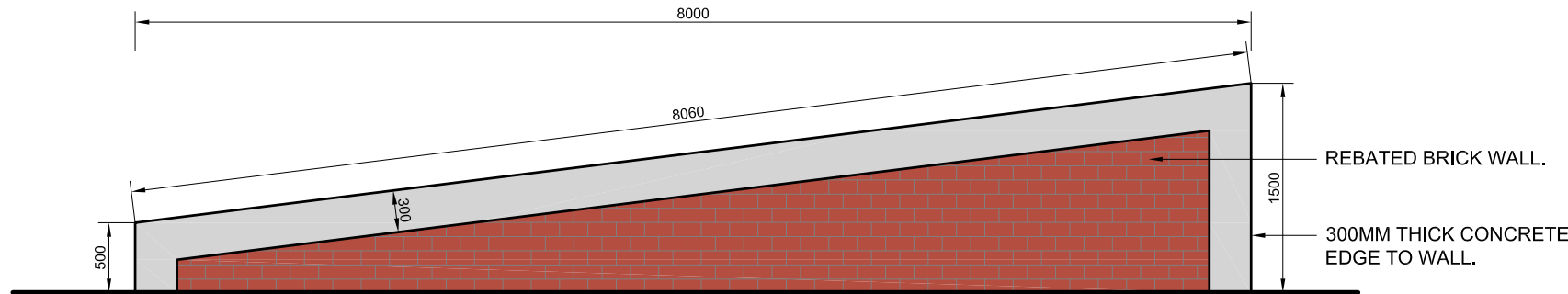

304 G ANGLED WALL - ELEVATION
SCALE 1:50

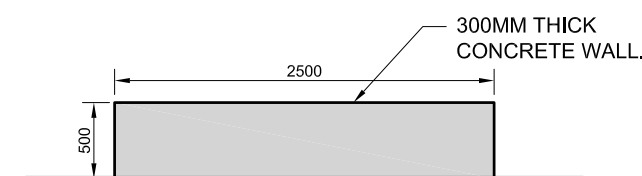

304 H 500MM HIGH WALL - ELEVATION
SCALE 1:50

CONVIC

unit 13 46/50 regent street richmond victoria - australia - 3121
ph: +613 9486 9899 fax: +613 9486 9088 www.convic.com

Project
Esplanade Youth Plaza
Esplanade Reserve,
Fremantle, WA

Drawing Title
PARKOUR WALLS

Drawn Checked Scale Date
AH (CONVIC) NL (CONVIC) 1:100 @ A1 03.06.13

Drawing Number
12808_C304
Revision
-

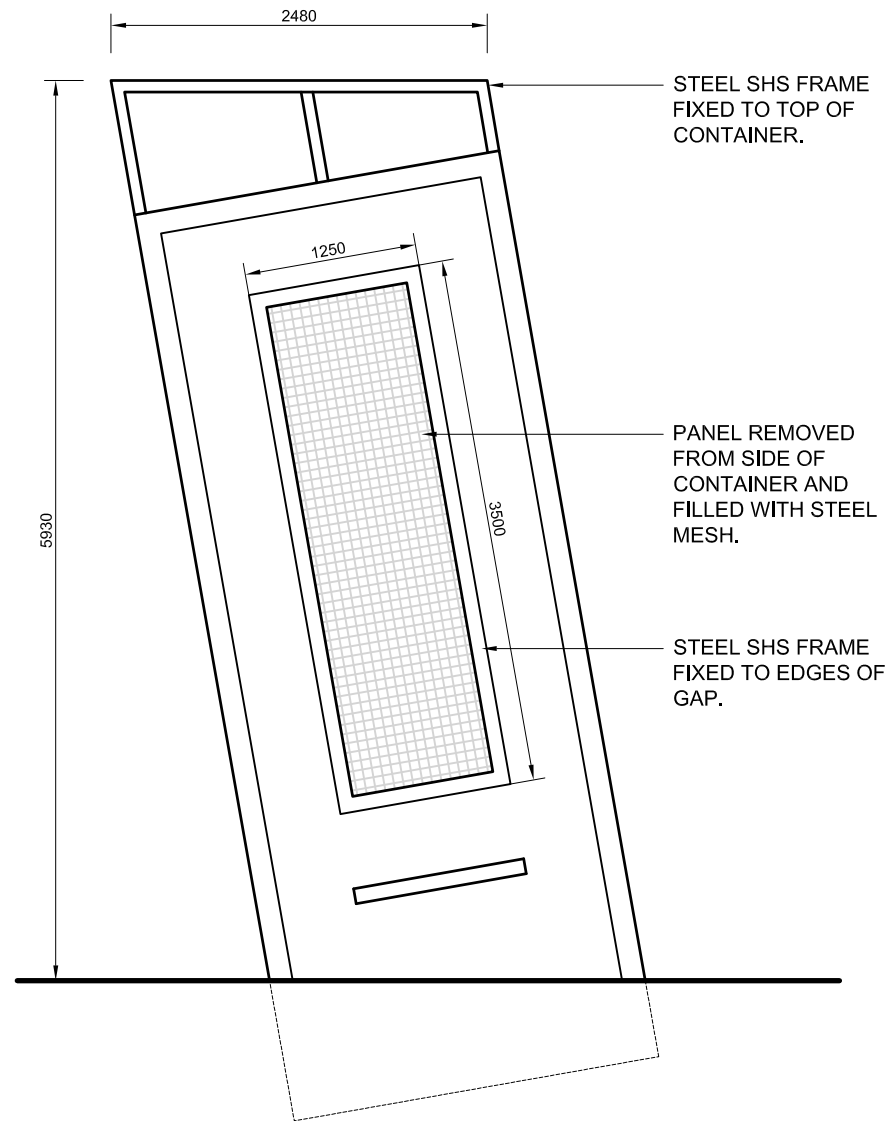

304
B PARKOUR SHIPPING CONTAINER SECTION
SCALE 1:100

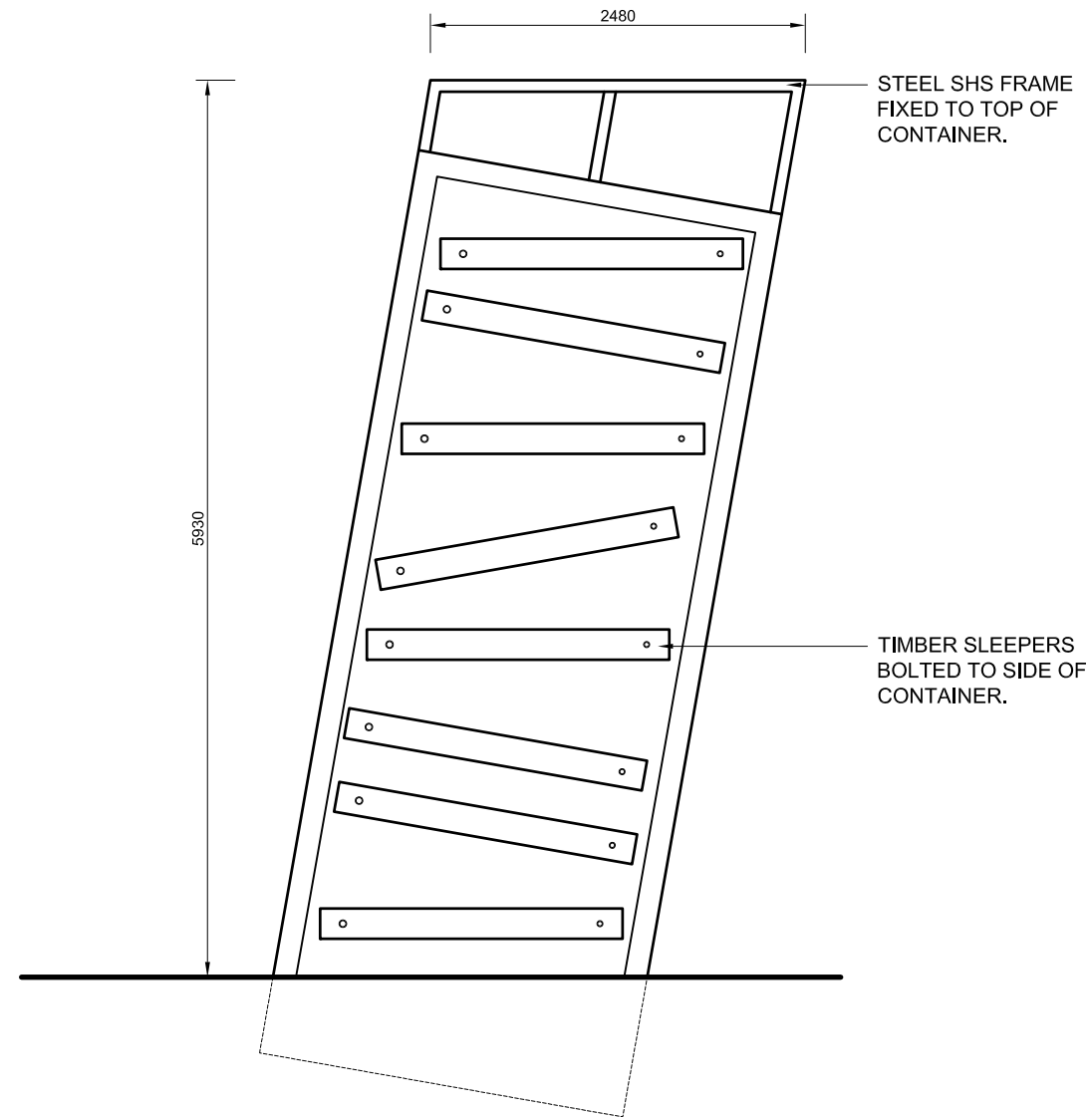

304
C PARKOUR SHIPPING CONTAINER SECTION
SCALE 1:100

CONVIC

unit 13 46/50 regent street richmond victoria - australia - 3121
ph: +613 9486 9899 fax: +613 9486 9088 www.convic.com

Project

Esplanade Youth Plaza
Esplanade Reserve,
Fremantle, WA

Drawing Title

PARKOUR CONTAINERS

Drawn	Checked	Scale	Date
AH (CONVIC)	NL (CONVIC)	1:50 @ A1	03.06.13

Drawing Number	Revision
12808_C305	-

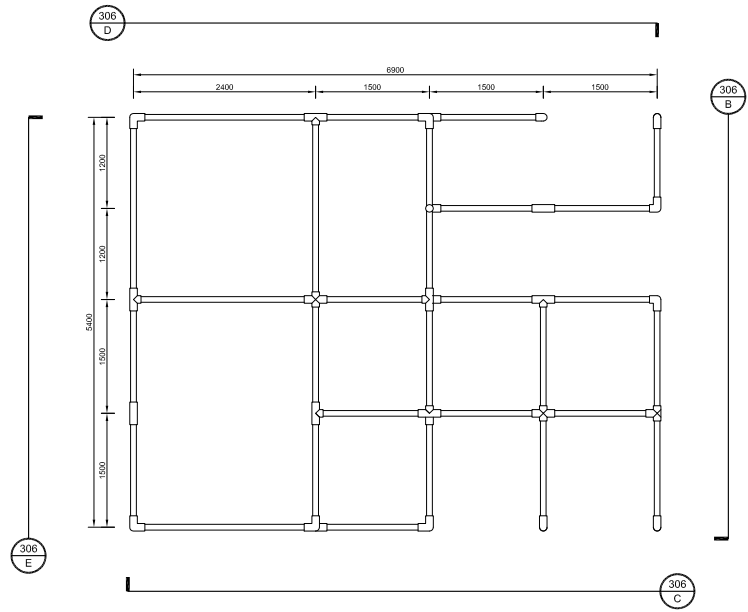

306
A **PARKOUR STEEL FRAME - PLAN**
SCALE 1:100

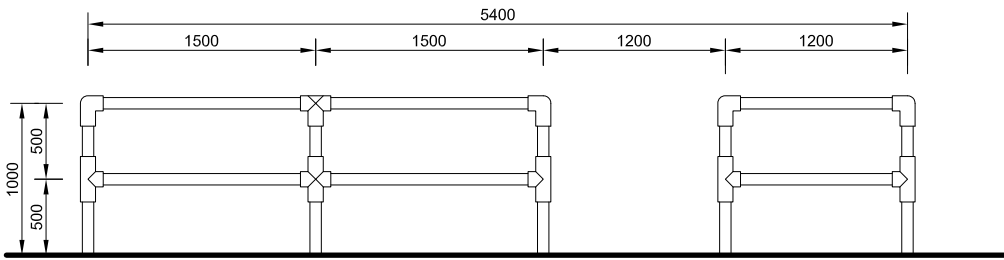

306
B **STEEL FRAME ELEVATION**
SCALE 1:50

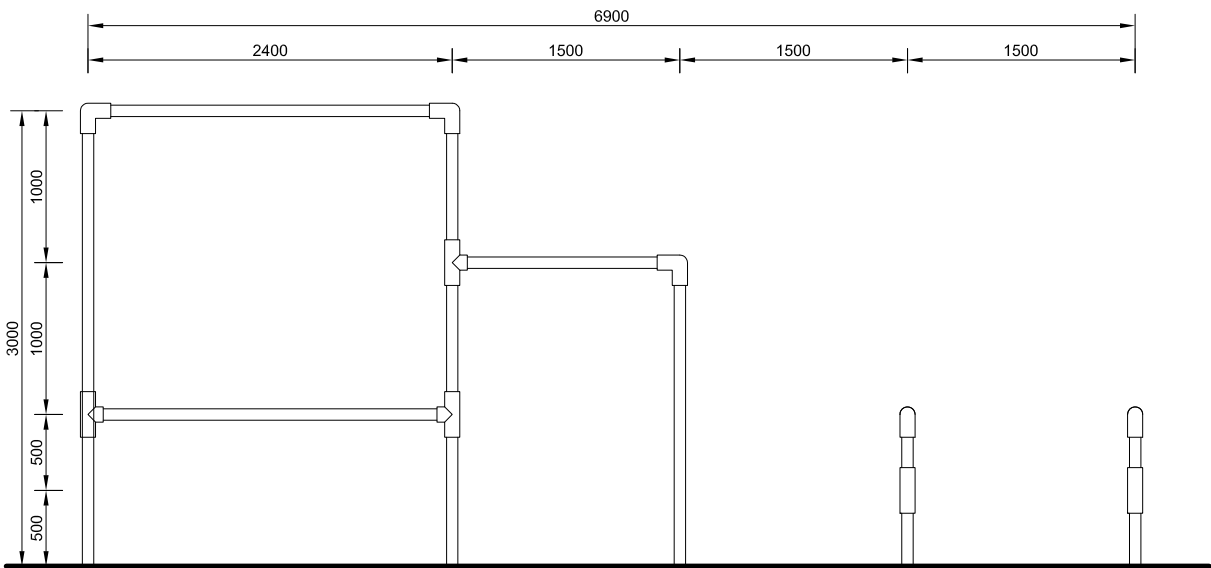

306
C **STEEL FRAME ELEVATION**
SCALE 1:50

306
C **STEEL FRAME ELEVATION**
SCALE 1:50

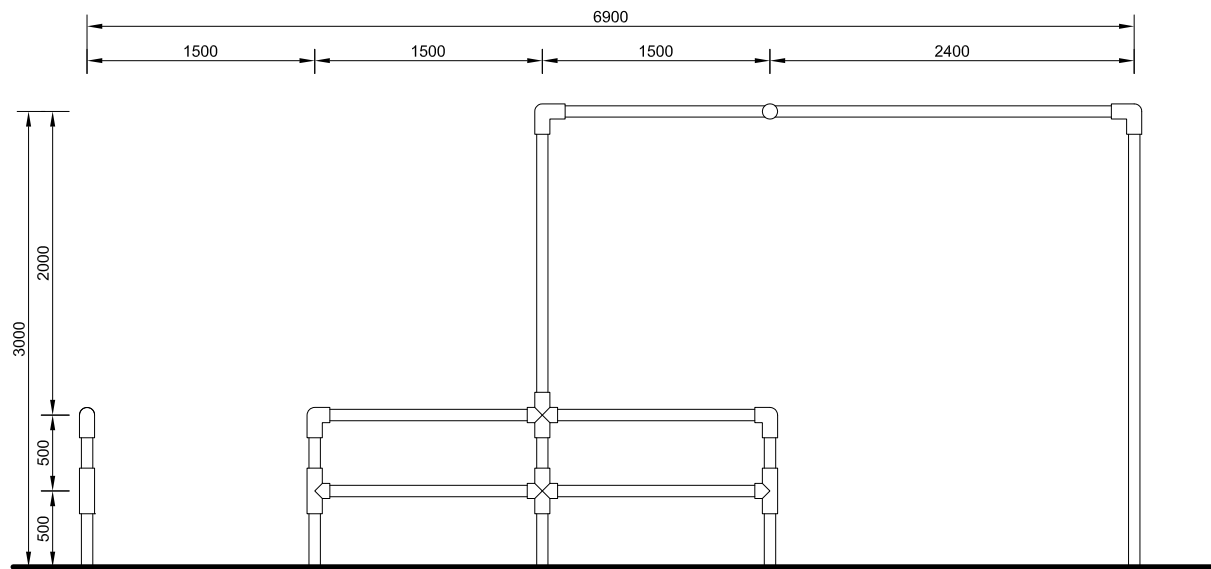

306
D **STEEL FRAME ELEVATION**
SCALE 1:50

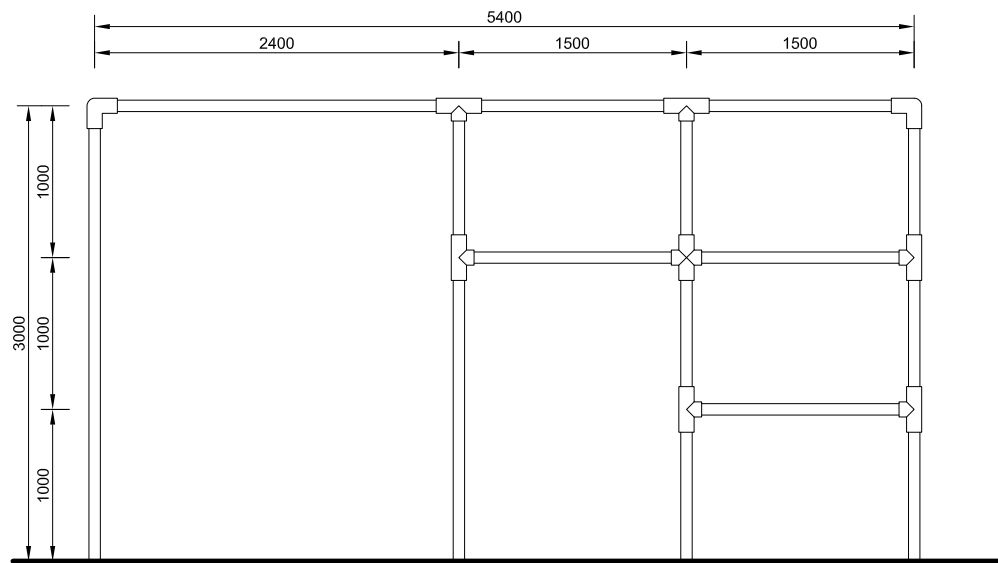

306
E **STEEL FRAME ELEVATION**
SCALE 1:50

CONVIC

unit 13 46/50 regent street richmond victoria - australia - 3121
ph: +613 9486 9899 fax: +613 9486 9088 www.convic.com

Project
Esplanade Youth Plaza
Esplanade Reserve,
Fremantle, WA

Drawing Title
PARKOUR STEEL FRAME

Drawn AH (CONVIC)	Checked NL (CONVIC)	Scale 1:100 @ A1	Date 03.06.13
----------------------	------------------------	---------------------	------------------

Drawing Number 12808_C306	Revision -
-------------------------------------	----------------------

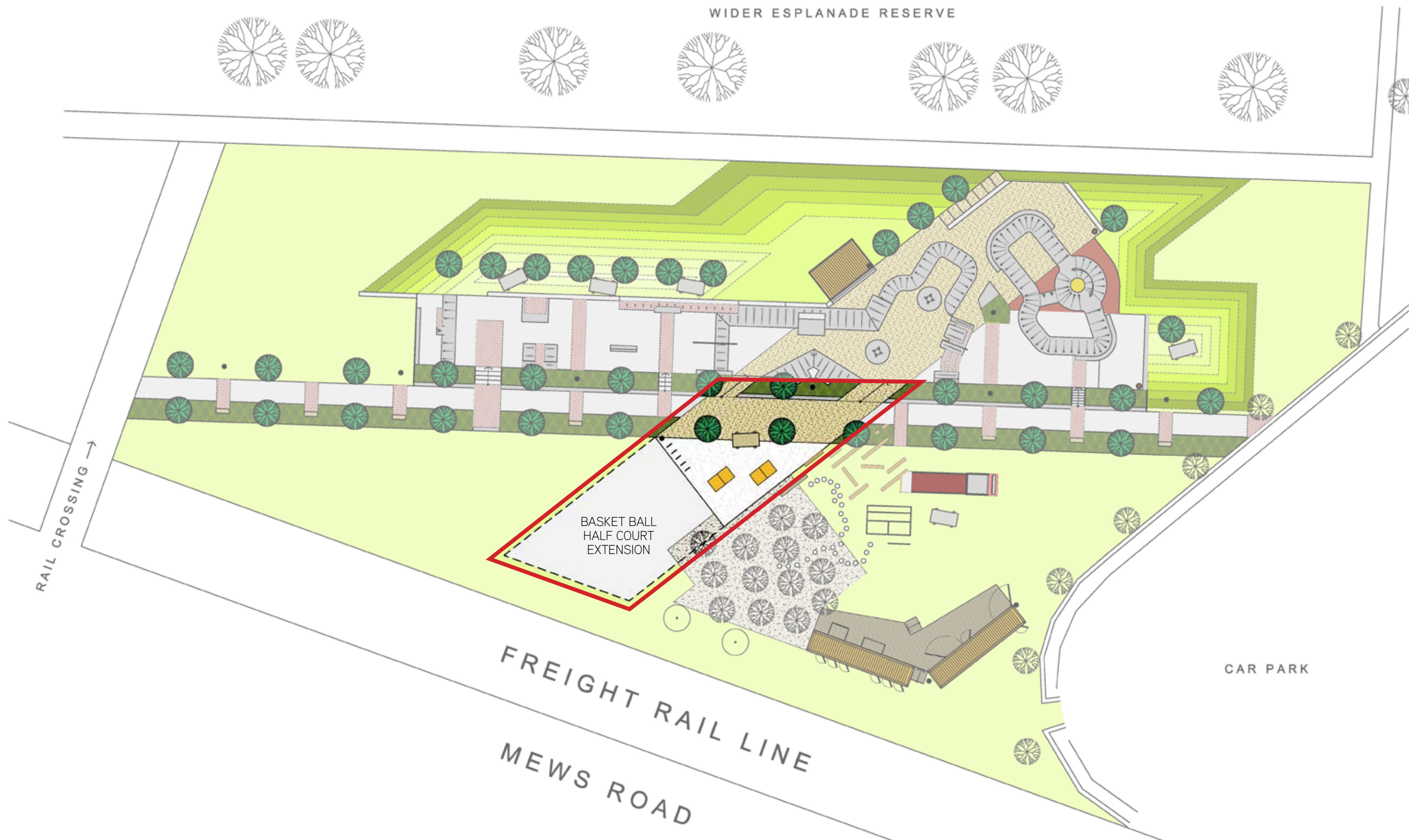

BASKETBALL + TABLE TENNIS AREA

BASKET BALL + TABLE TENNIS

The central band which is highlighted through exposed aggregate surface material, cuts through the central spine from the skate plaza and creates an area for active ball sports to the south of the site. This connects the spaces through landscape treatment and highlights the entrance to the space.

This part of the design is to be staged into two concise phases. The first consists of two outdoor table tennis tables and cycle parking within a granitic sand surface treatment. These elements will then be relocated in the subsequent stage, which extends the exposed aggregate central band, creating an ideal surface for a half basket ball court.

The adjacent plan illustrates the first phase with the table tennis courts in location and the hatch area illustrating the area associated with the basket ball court extension.





SKATE AREA

A LOW PROFILE SKATE PLAZA WITH UNIQUE STREET ELEMENTS, ENCLOSED BOWL AND INTEGRATED MINI RAMP ARE ALL CONNECTED TO CREATE CONTINUOUS SKATE RUNS. THE YOUTH PLAZA HAS A SIGNIFICANT FOCUS ON SKATE, BMX AND SCOOTER ACTIVITIES.

SKATE BOWL

A bowl is located at the east side of the site. This is positioned to provide clear views towards the rail crossing from the surrounding park. A reclaimed buoy is integrated into the bowl. This provides a unique skate function and iconic central feature point. The deeper end of the bowl will include a very tight corner pocket and varied transition heights, which opens into the shallower end of the bowl with a 300mm high level change and a peaked hip. The lower end of the bowl has a 1.2m high section to act as a mini-ramp which increases height around the closed end.

SKATE PLAZA

The central areas contrast in character creating unique street style obstacles. A variety of ledges, manual pads, banks, hips, and rails provide a range of elements for creative users, fostering skill progression. Obstacles will be well spaced to allow full function of all elements with more space for run-up and landing to increase flow and create continuous skate lines around the street plaza.

One shelter is provided in this area. It is a double height shelter so it can also function as a focal stage for events and performances such as bands, DJs, competitions, etc.

Concrete will be used throughout the majority of the space as the preferred usable surface. The concrete palette will be accentuated and detailed with splashes of colour and the unique integration of selected materials such as brick and steel. This will add contrasting skateable textures, materiality and colour into the space, providing a visually stunning public open space feature.

Trees will be planted throughout the space to provide additional shade and amenity and added softness to the plaza and integrate it into the wider reserve green space.



VIEW TOWARDS SKATE PLAZA



SECTION AA SCALE 1:50 @ A3



SECTION BB SCALE 1:50 @ A3

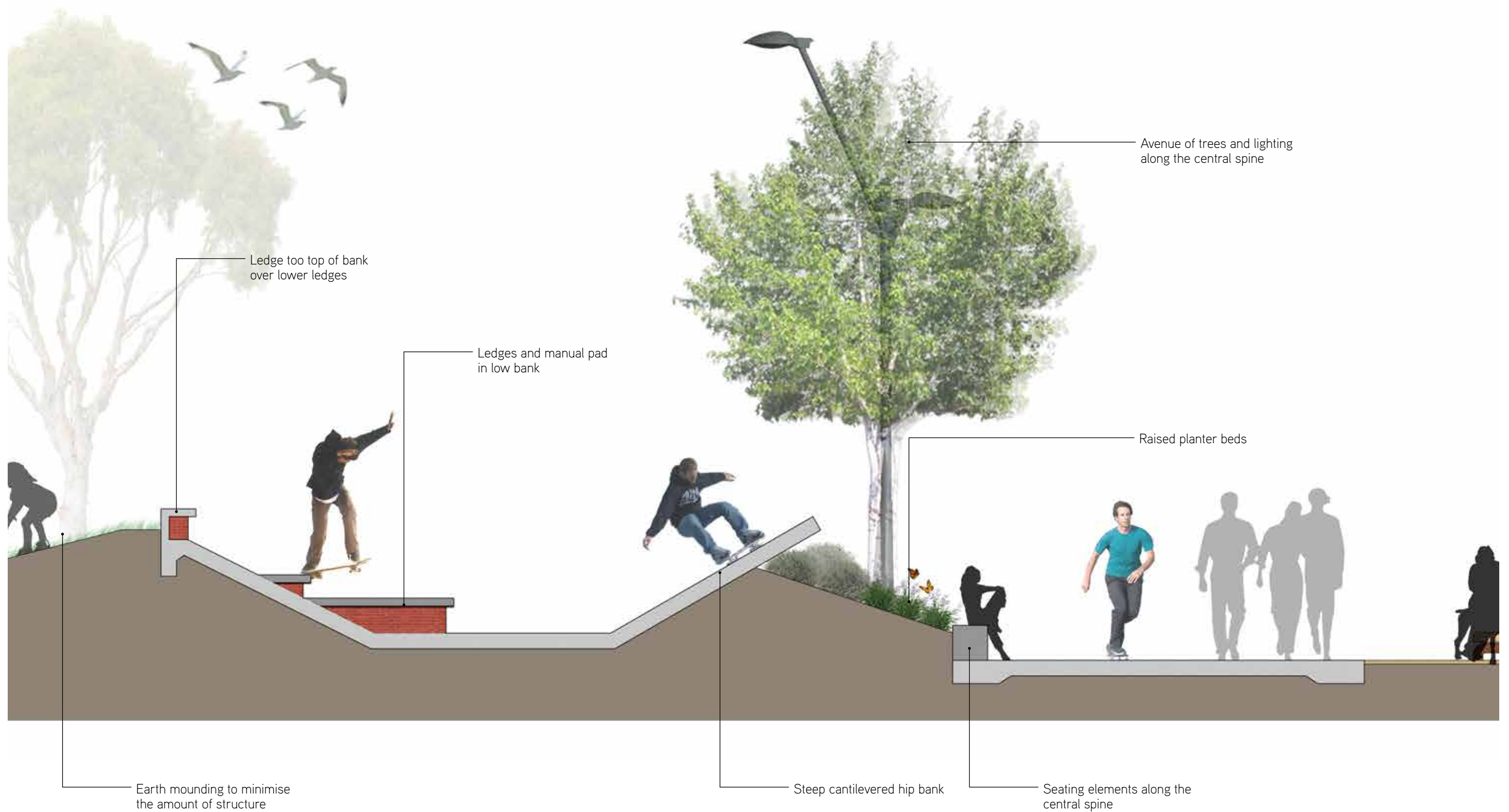

VIEW INTO BOWL



SECTION CC SCALE 1:50 @ A3



MATERIAL PALETTES

MATERIALS PALETTE

The material finishes and textures to the plaza play a key role in the integration of this development within the surrounding area. Materials have been selected to reflect Fremantle’s rich industrial past and be in keeping with its surrounding context. The plaza will reinforce Fremantle’s and the Esplanade Reserve’s strong history within the paving geometries creating strong dynamic lines.

- Red bricks respond to the surrounding architectural tone whilst also linking back to the history of the Woolstores.
- Cor ten steel interprets the historic rail line and the full carriages that once moved through the space.
- Timber sleepers reflect the rail line, and also highlights the rich maritime and ship building history and wharves.
- Concrete will be utilised as a smooth texture rolling surface, juxtaposed against the other feature materials in a skateable future.

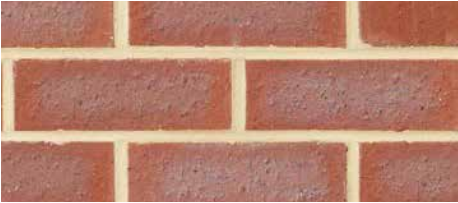

M1 - RED BRICK
Colour: Traditional
Finish: Tumbled - upright faces
Smooth - paving
Size: 230 x 110 x 76mm



M2 - COR TEN STEEL
Self oxidizing patina finish.
Sheet size: 2400 x 1200mm



M3 - TIMBER SLEEPERS
Timber: Ironbarks, spotted gum, white cypress pine and other durable timbers.



M4 - CONCRETE
Colour: Grey tones and Sparta
Finishes: Exposed aggregate and honed.



=



=



=



=



PLANTING PALETTES

PLANTING PALETTE

The planting responds to the linearity of the site and design and provides a soft landscape visual to the more robust qualities of the youth plaza, and combines a natural landscape character with a contemporary design response.

The planting is designed to soften the transition from the hard nature of the plaza to the grassed expanses of the wider park, whilst also providing all year interest of colour and architectural structure in linear bands. This pattern is softened through natural planting of feathery grasses and feature architectural plant species providing a dynamic sense of movement and structure reflecting the active nature of the site.

Tree species are selected to complement the existing Norfolk Pines and to highlight the more recent section of the Esplanade Reserve.

With advice from council coastal species are to be selected that are salt tolerant, hardy and can adapt to inundation.

TREES

Agonis flexuosa
Casuarina equisetifolia
Lagerstroemia indica
Melaleuca sp.



Agonis flexuosa



Casuarina equisetifolia



Melaleuca sp.

SHRUBS

Anigozanthos flavidus
Grevillea sp.
Hardenbergia violacea
Leucadendron 'Inca Gold'
Lomandra confertifolia
Lomandra hystrix
Raphiolepis indica
Westringia fruticosa



Anigozanthos flavidus



Hardenbergia violacea



Leucadendron 'Inca Gold'



Lomandra hystrix



Raphiolepis indica



Westringia fruticosa

GROUND COVERS

Acacia baileyana
Casuarina glauca prostrate "Free Fall"
Dianella caerulea "Little Jess"
Eutaxia obovata
Ophiopogon japonicus
Pandorea jasminoides
Pennisetum alopecuroides "Nafray"
Stachys lanata "Lamb's Ear"



Acacia baileyana



Casuarina glauca prostrate



Dianella caerulea



Eutaxia obovata



Ophiopogon japonicus

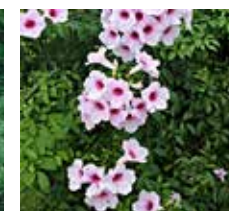

Pandorea jasminoides



Pennisetum alopecuroides



Stachys lanata

FURNITURE PALETTES

FURNITURE PALETTE

The furniture will reflect the industrial past of Fremantle by utilising robust raw materials, such as steel and timber sleepers. Reclaimed timber from the Woolstores will be restored and made into seating and other features around the site.

Where possible elements will be reappropriated to create innovative new functions, for example converting the old buoy into a major icon and skateable feature.



1// Bike Parking Racks



2// Lighting Columns



3// C300_E Timber Sleeper / Recycled Timber Seating



4// Converted Shipping Container

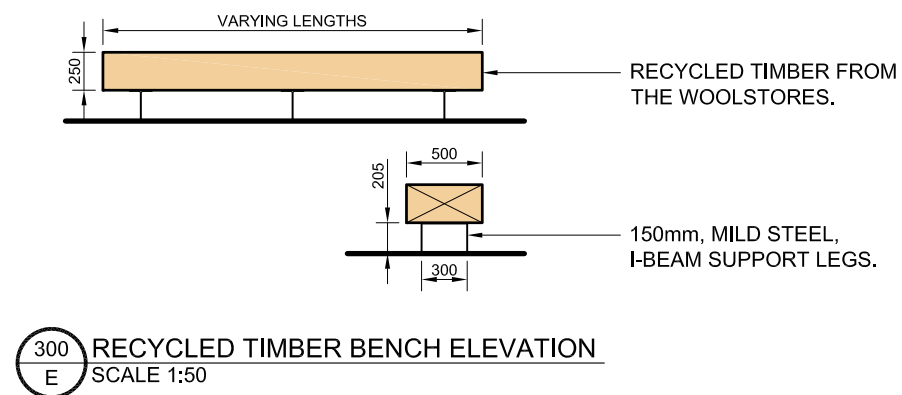
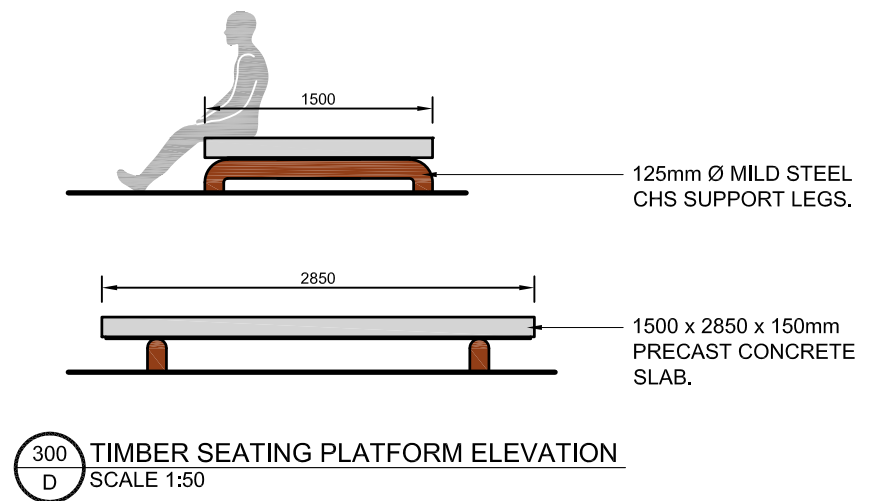
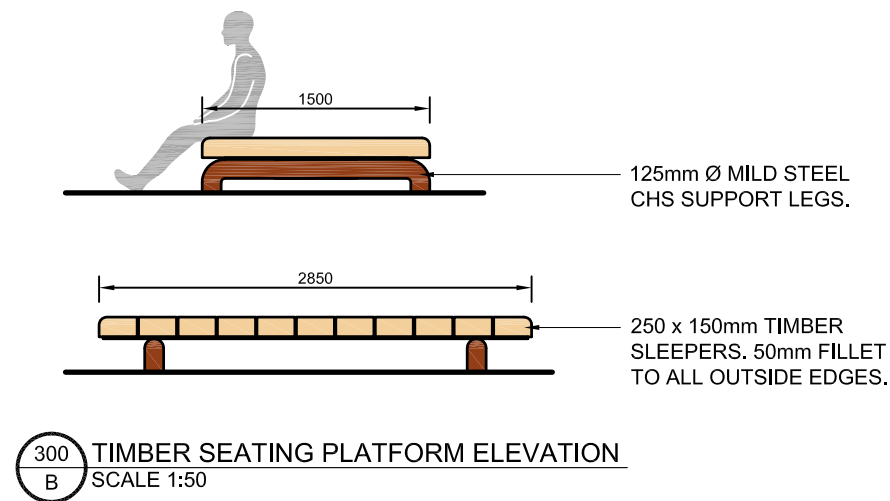
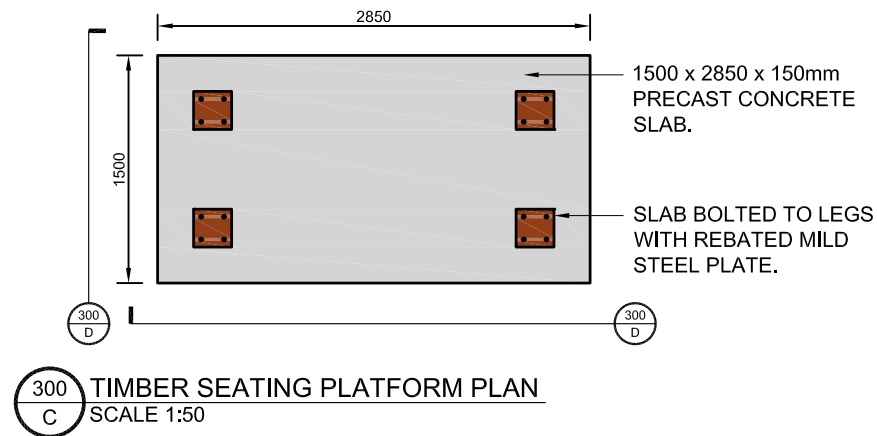
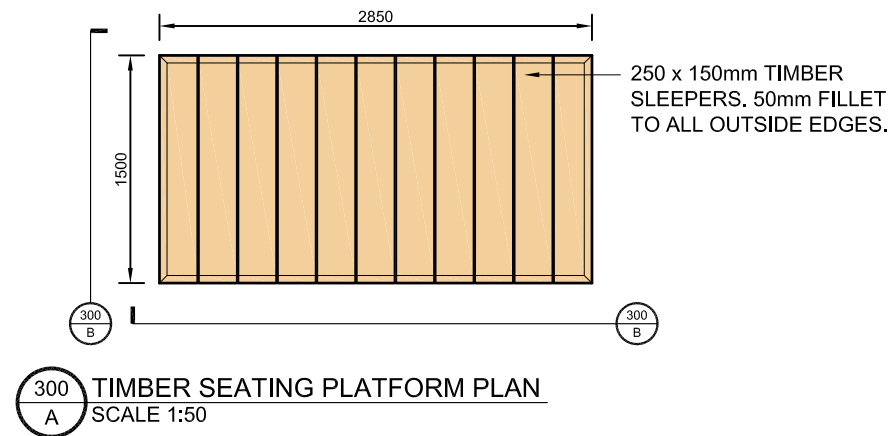

CONVIC

unit 13 46/50 regent street richmond victoria - australia - 3121
ph: +613 9486 9899 fax: +613 9486 9088 www.convic.com

Project
Esplanade Youth Plaza
Esplanade Reserve,
Fremantle, WA

Drawing Title
SEATING DETAIL

Drawn	Checked	Scale	Date
AH (CONVIC)	NL (CONVIC)	1:100 @ A1	03.06.13

Drawing Number	Revision
12808_C300	-

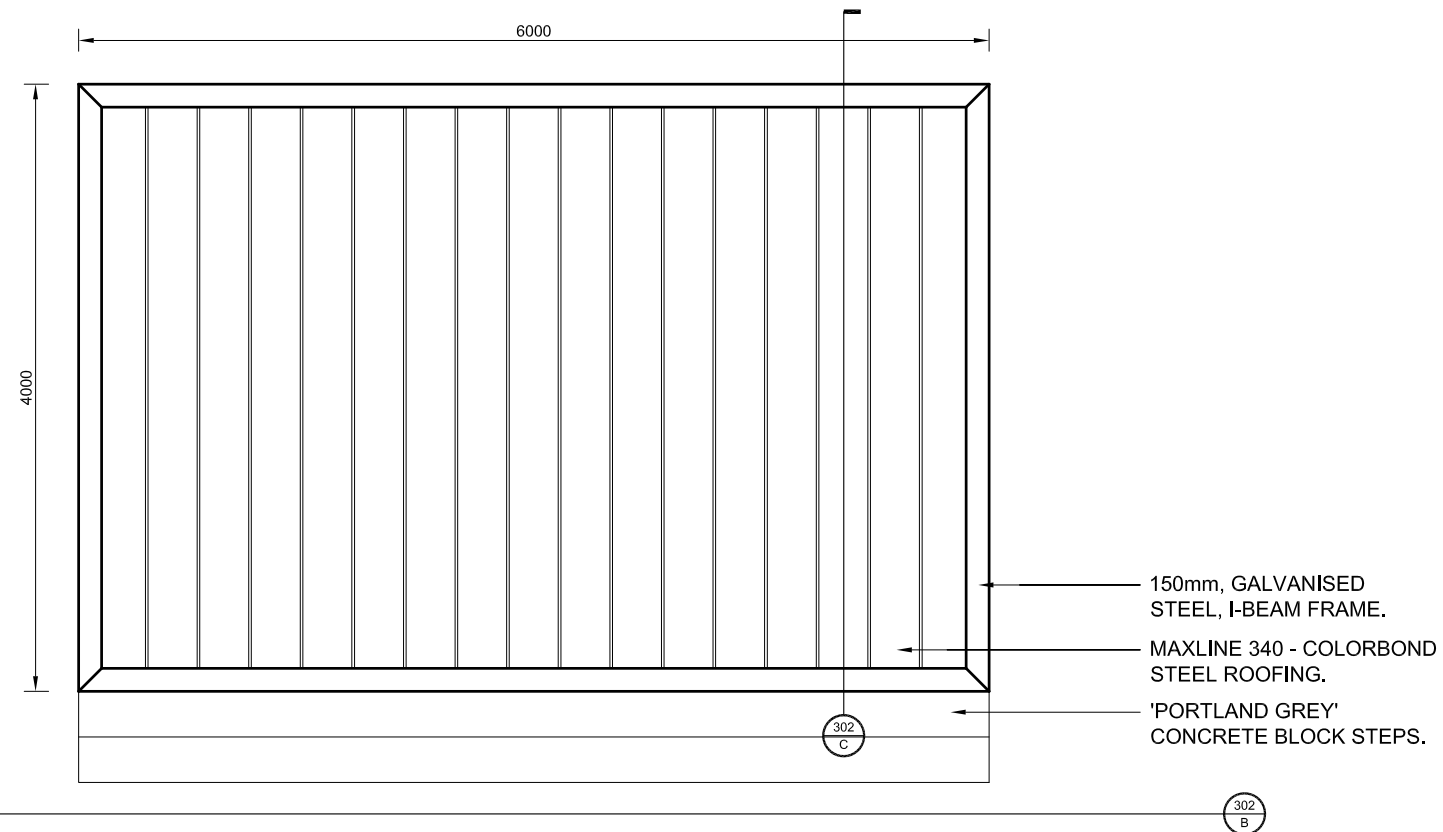

200 SHADE SHELTER PLAN
A SCALE 1:50

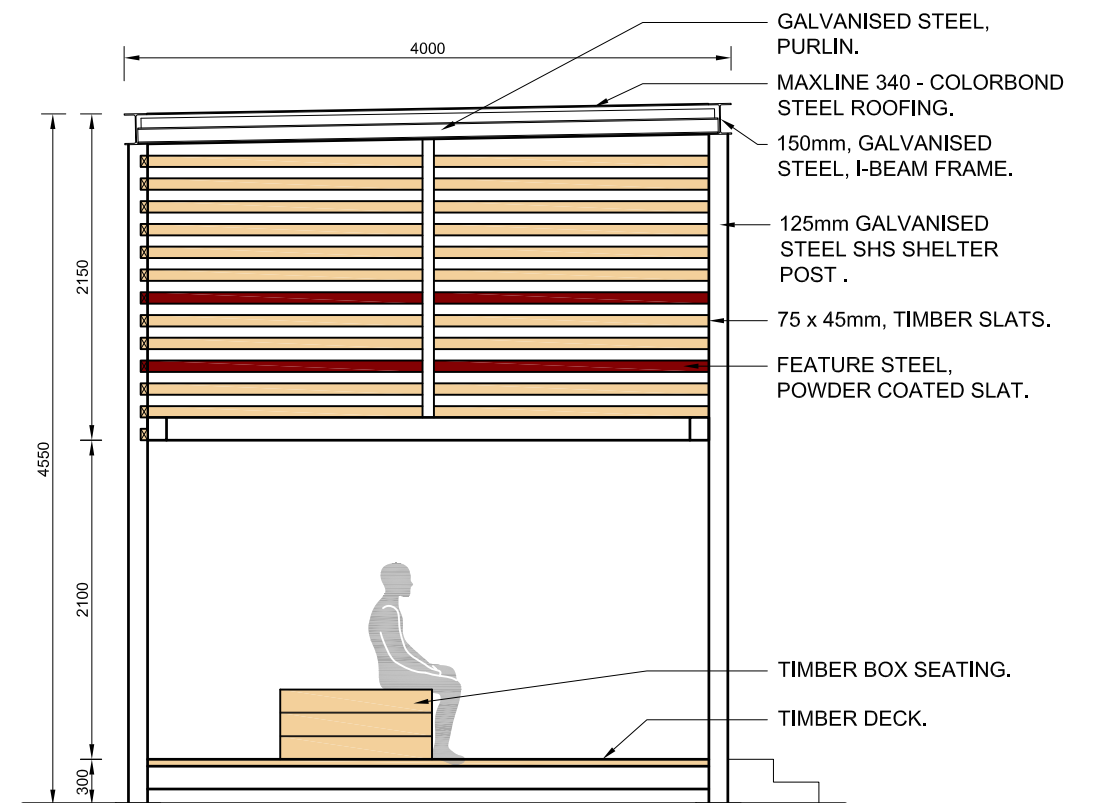

302 SHADE SHELTER SECTION
C SCALE 1:50

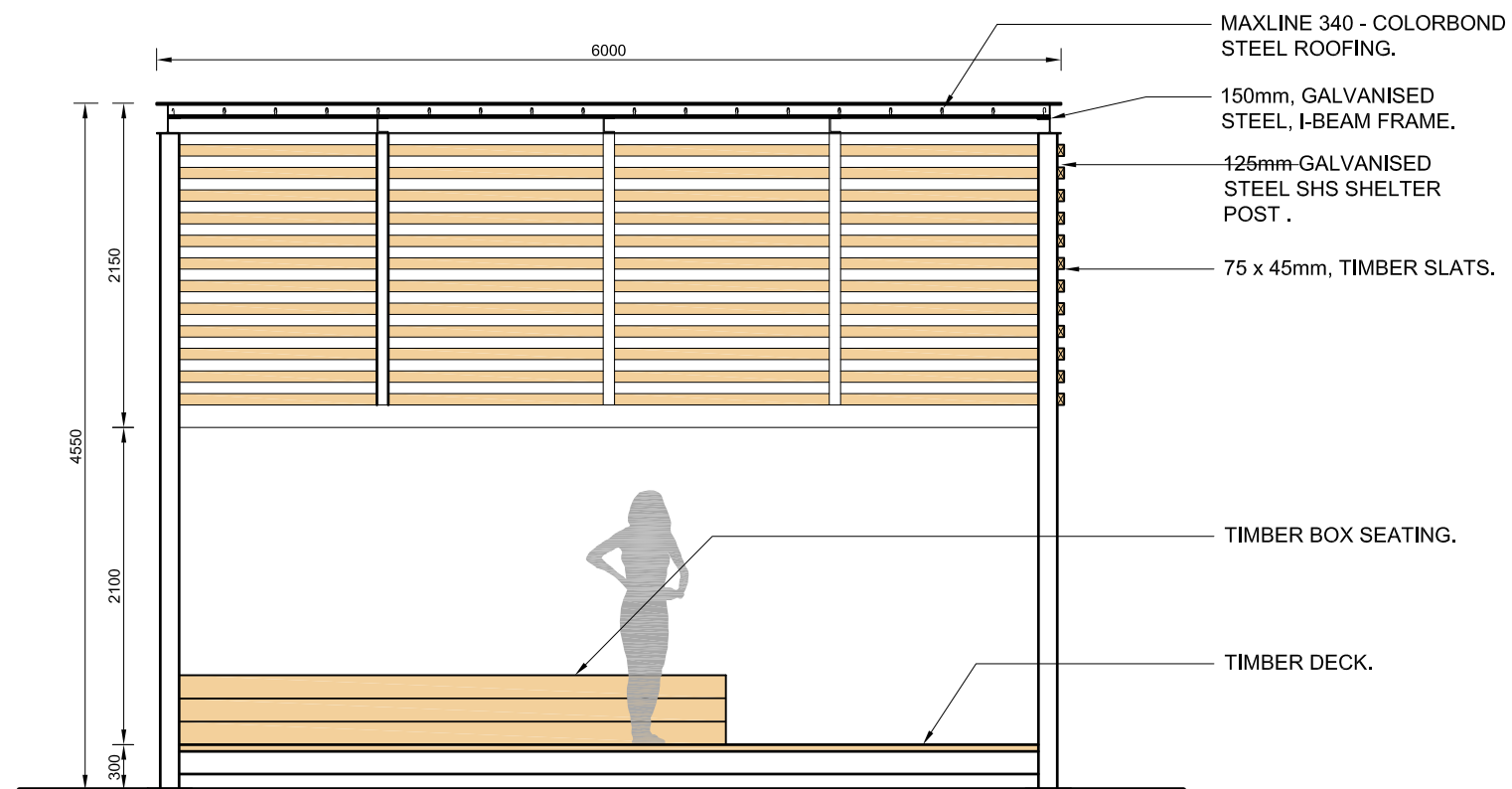

302 SHADE SHELTER SECTION
B SCALE 1:50

CONVIC

unit 13 46/50 regent street richmond victoria - australia - 3121
ph: +613 9486 9899 fax: +613 9486 9088 www.convic.com

Project
Esplanade Youth Plaza
Esplanade Reserve,
Fremantle, WA

Drawing Title
STAGE SHELTER DETAIL

Drawn	Checked	Scale	Date
AH (CONVIC)	NL (CONVIC)	1:100 @ A1	03.06.13

Drawing Number	Revision
12808_C302	-

LIGHTING PALETTE

The lighting palette aims to create usable, iconic and safe night time space. This will be achieved through several lighting types and techniques, such as flood lighting for active sport usability, pedestrian lighting creating delineation and safety along key routes at night, and feature lighting which highlights key features and also creates an iconic night time setting.



L1 - FLOOD LIGHTING
 WE-EF 108-1172 VFL 530 [S70]
 LED - 24/48W

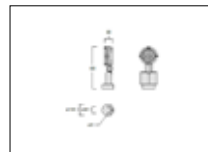

L2 - PEDESTRIAN LEVEL LIGHTING
 WE-EF 108-1172 VFL 530 [S70]
 LED - 24/48W

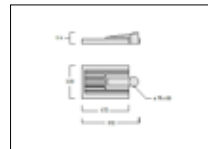

L3 - FEATURE LIGHTING



GRAPHICS AND WAYFINDING

YOUTH PLAZA LOGO

The logo aims to create a graphical mark or emblem that can be used through the plaza itself, on any marketing material, and on advertising for events ect. This logo will create an iconic brand and distinct identity to the Youth Plaza, harnessing the parks historic past and proposed functions.

The logo shall also be utilised as a wayfinding devise throughout the park. Illustrating programmed functions in each identified zone.

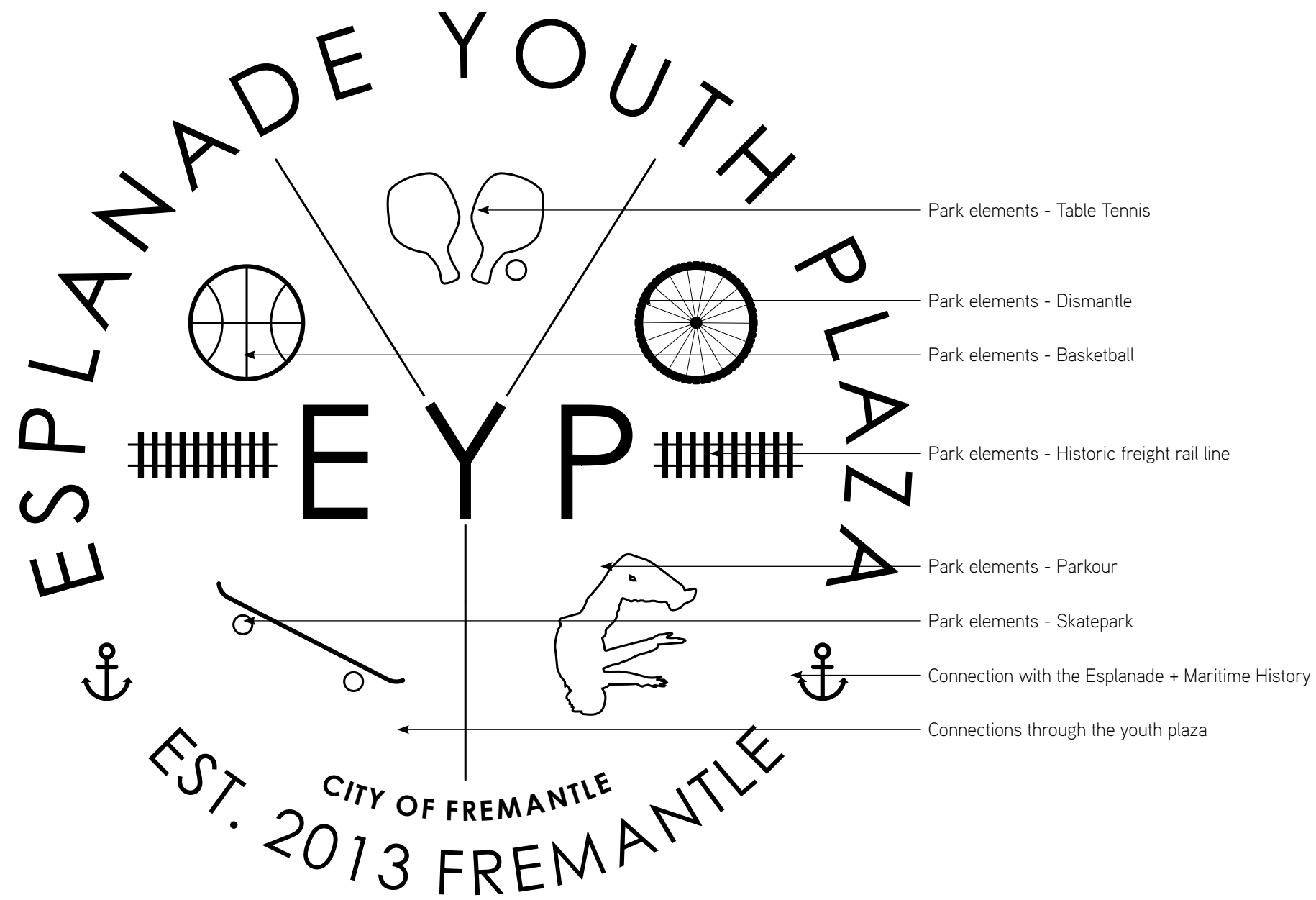

Wayfinding Logos.



The logo shall be represented in several different formats including steel set into concrete, etched into timber, painted and rebated into concrete.

CONVIC

UNIT 13, 46-50 REGENT STREET
RICHMOND VIC 3121 AUSTRALIA
T +61 3 9486 9899 F +61 3 9486 9088
CONVIC.COM