

FIRST FLOOR

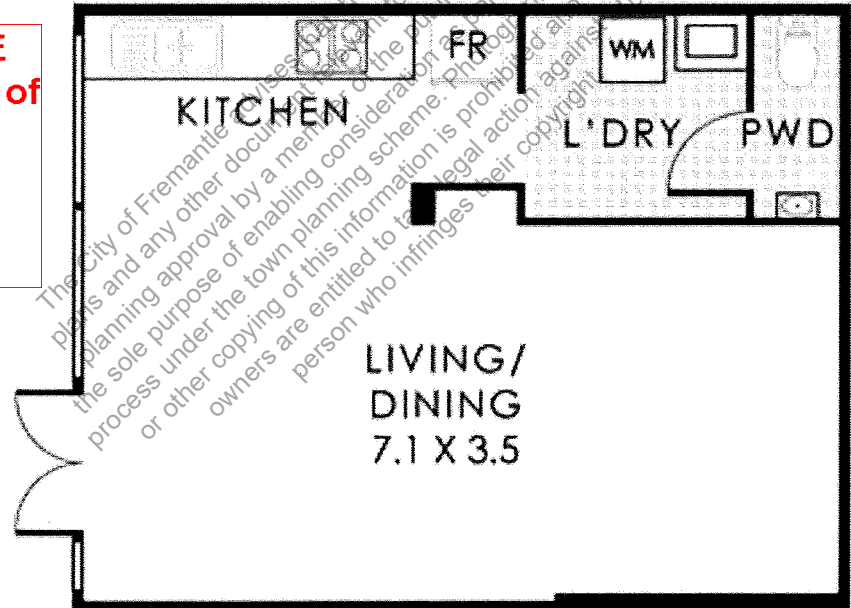

GROUND FLOOR

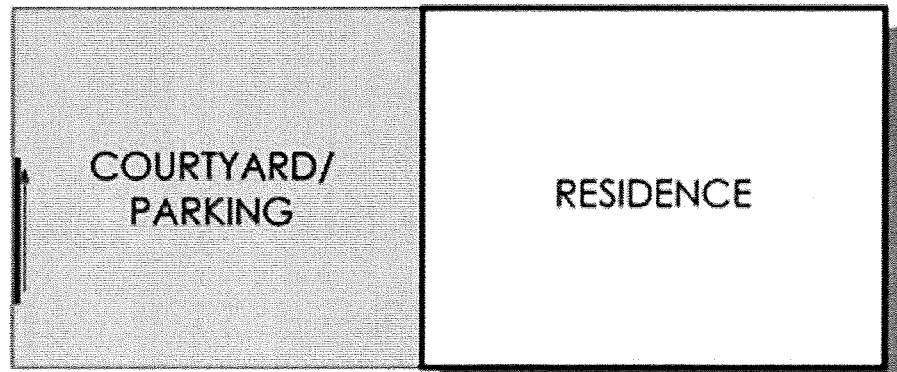

SOUTH TERRACE

CITY OF FREMANTLE
 These Plans Form Part of
DA0212/26
4 June 2026

7/342 South Terrace, South Fremantle

Residence 67m² | Balcony 5m²

Management Plan

1. Contact details of the property manager: [REDACTED].
Email: [REDACTED]
2. Onsite second property manager: [REDACTED] (lives in the building and member of strata board); Mobile [REDACTED] Email: [REDACTED]
3. Method of booking and checking in: AirBnB and Stayz platforms. Details messaged with code to lock box for self check in.
4. Confirmation of location of onsite parking: no onsite parking. One carpark for guests is located in the property courtyard (see floorplan).
5. Pets are not permitted at the property.
6. No more than 4 guests are permitted to stay.
7. Complaint management procedure: Any and all complaints about guests are to be addressed to [REDACTED] Phone number will be clearly displayed on the front gate. For immediate onsite attendance, complaints can be addressed to [REDACTED] (a resident in the complex and member of Strata council) whom I will contact on [REDACTED].
8. Waste management strategy: Guests to place bins on the kerbside on collection days. In the event a guest omits or neglects to do this, [REDACTED] (resident of Unit 12) will attend to bin placement.
9. Bushfire emergency response procedures: not applicable.

Code of Conduct

1. Contact details of Property Manager - see Management Plan.
2. Expected behaviour of guests and residents: guests and residents are expected to not engage in nuisance and to respect and permit all neighbours' quiet enjoyment, privacy, and good order of their premises, including no unreasonable and substantial noise, no gatherings of guests' visitors of more than four people, no smoking and no interference in car parking. Similarly, guests are guaranteed reasonable peace, comfort and privacy without interference or interruption (Residential Tenancies Act 1987).
3. On-site parking: 1 on-site park is provided for guests. Complaints about unauthorised on-site parking should be directed to the property manager. Public transport is available from a stop immediately outside the premises, as is off street parking.
4. Guests are required to dispose of waste by placing bins on the roadside outside the premises on Tuesday evening for Wednesday am collection.
5. Pets are not permitted on the property. Guests must not endeavour to feed local wildlife including birds.